

PROJECT NAME: FRONTIER

PROJECT NO: 2025-03

PROJECT ADDRESS: 102-118 Haliburton St
Nanaimo, BC

DATE: 2025-06-12

ISSUED FOR: Issue for Review

TABLE OF CONTENTS	
Sheet Number	Sheet Title
L0	Landscape Cover Sheet
L2a	Landscape Materials and Layout Plan
L2b	Landscape Materials and Layout Plan
L2d	Landscape Lighting Plan
L3a	Landscape Planting Plan
L3b	Landscape Planting Plan
L4	Landscape Sections
L5a	Landscape Details
L5b	Landscape Details
L5c	Landscape Cut Sheets

CONSULTANT LIST
CLIENT: DIFFERENTIAL BUILDERS
ARCHITECT: MATT HANSON ARCHITECTURE

CONTEXT PLAN



PACKAGE IS ONLY TO SCALE WHEN
PRINTED ON 24"X36" SHEETS UNLESS
OTHERWISE INDICATED

RECEIVED
DP1389
2025-JUN-19
Current Planning

2025-06-12
2025-05-14

Issue for Review
Issue for Review

Date	Issue Notes
Seal	
<div>↑</div>	

Prospect & Refuge

LANDSCAPE ARCHITECTS

Building on 25 years of history as Jonathan Loree, Ltd.

416 W Pender St | Vancouver, BC | V6B 1T5
t: 604-669-1003 | e: info@prospectrefuge.ca | w: prospectrefuge.ca

Project Title and Address

FRONTIER
102-118 Haliburton St
Nanaimo, BC

First Nations Territory

Snuneymuxw First Nation

Sheet Title

Landscape Cover Sheet

Project No.	Scale
2025-03	As noted
Project Manager	Sheet No.
Reviewed By	L0
AS	

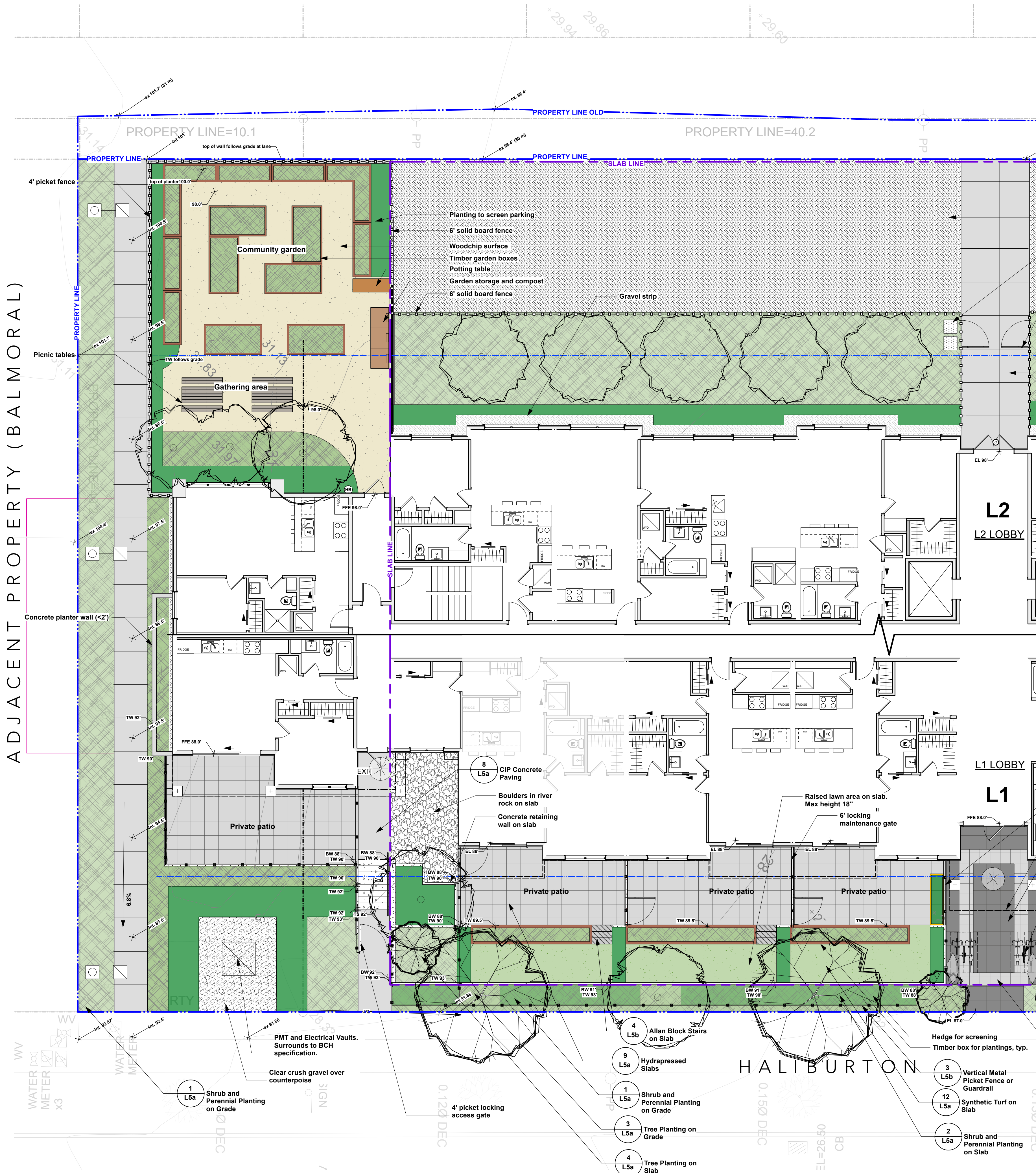

LANDSCAPE GENERAL NOTES

1. All Landscape material and execution shall conform to the Canadian Landscape Standard; all applicable and noted codes, bylaws and specifications; and life-safety requirements.
2. Do not construct from these drawings unless marked "Issued For Construction".
3. The Landscape Contractor shall submit all questions, reports, inquiries and requests pertaining to these drawings or their execution in writing to the Landscape Consultant.
4. Existing condition plans were prepared by others and actual conditions may vary from those shown. The Landscape Contractor shall conduct a site visit to review existing conditions and report all discrepancies between the plans and actual site to the Landscape Consultant prior to construction. The Landscape Contractor shall assume responsibility for actual site conditions (including subsurface).
5. The Landscape Contractor shall conduct a site visit and review to determine the extent of work required (including but not limited to demolition, preparation and removals). Landscape Contractor shall report any discrepancies between the required and proposed work, to the Landscape Architect prior to construction.
6. The Landscape Contractor shall verify all scaled and written dimensions in the contract drawings and on site prior to construction. The Landscape Contractor shall report any discrepancies or incompatibilities to the Landscape Consultant.
7. Provide positive grades away from buildings and toward lawn drains and catch basins. Slope away from building at a minimum of 2%.
8. All landscaping shall have a high efficiency irrigation system to IABC standards. Unless otherwise specified, the irrigation system shall be design-built by the Irrigation Contractor. The Irrigation Contractor shall provide shop drawings for Landscape Consultant approval.
9. All substitutions shall be approved by the Landscape Consultant.
10. The Landscape Contractor shall repair any damage resulting from work on site.
11. The Landscape Contractor shall provide 1 year of CLS level 1 maintenance (including watering) after the date of substantial completion.
12. All walls 3' or taller, all guards, all concrete footings and all rebar shall be designed by structural engineer. All walls shall be inspected and approved by geotechnical and structural engineer. Ensure positive drainage behind all walls.
13. When working within the City of Vancouver, the Landscape Contractor shall ensure all project activities conform to Japanese Beetle Regulation

LANDSCAPE TREE NOTES

1. All landscape construction activities have a high potential for causing damage to trees, roots and soil. The Landscape Contractor shall coordinate with the project Arborist prior to the start of landscape operations to avoid tree protection non-compliance and bylaw issues.
2. Install temporary tree protection fencing as per arborist report or tree protection plan. Maintain the fencing during construction. No storage of materials or equipment, or any other activities are allowed within the protection zone during construction.
3. Removal of the tree barriers requires advance coordination and approval by the project arbor

LEGEND

- Property Line**
- Structural slab below**
- HARDSCAPE MATERIALS:**
- Core Gravel Reinforced Paving or approved equivalent
 - Hydrapressed Pavers on Slab
 - Saw-cut, broom finished concrete
 - Stamped concrete - Running Bond pattern
 - Plank pavers
 - Wood chip pathways
- SOFTSCAPE MATERIALS:**
- Planting Bed - Low plantings
 - Planting Bed - Hedge for screening
 - Artificial Turf lawn
- LINES & SYMBOLS**
- Building envelope
 - Building roof overhang

DETAIL

- 11 L5a
- 9 L5a
- 8 L5a
- 13 L5a
- 1 L5a
- 2 L5a
- 12 L5a

RECEIVED
DP1389
2025-JUN-19
Current Planning

2025-06-12 Issue for Review
2025-05-14 Issue for Review

Date Issue Notes

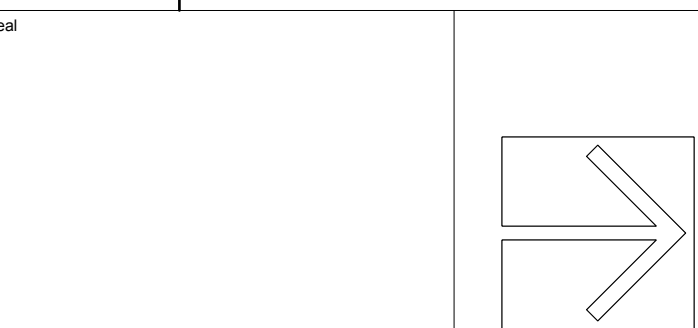

Prospect & Refuge

LANDSCAPE ARCHITECTS

Building on 25 years of history as Jonathan Lowe, Ltd.

416 W Pender St | Vancouver, BC | V6B 1T5
t: 604-669-1003 | e: info@prospectrefuge.ca | w: prospectrefuge.ca

Project Title and Address

FRONTIER
102-118 Haliburton St
Nanaimo, BC

First Nations Territory

Snuneymuxw First Nation

Sheet Title

Landscape Materials and Layout Plan

Project No.	Scale
2025-03	As noted
Project Manager	Sheet No.
Reviewed By	
AS	L2a

3 Materials & Layout Plan

Scale: 1/8" = 1'-0"

0 10 15 20 ft



Project No. 2025-03	Scale As noted
Project Manager	Sheet No. L2b
Reviewed By AS	

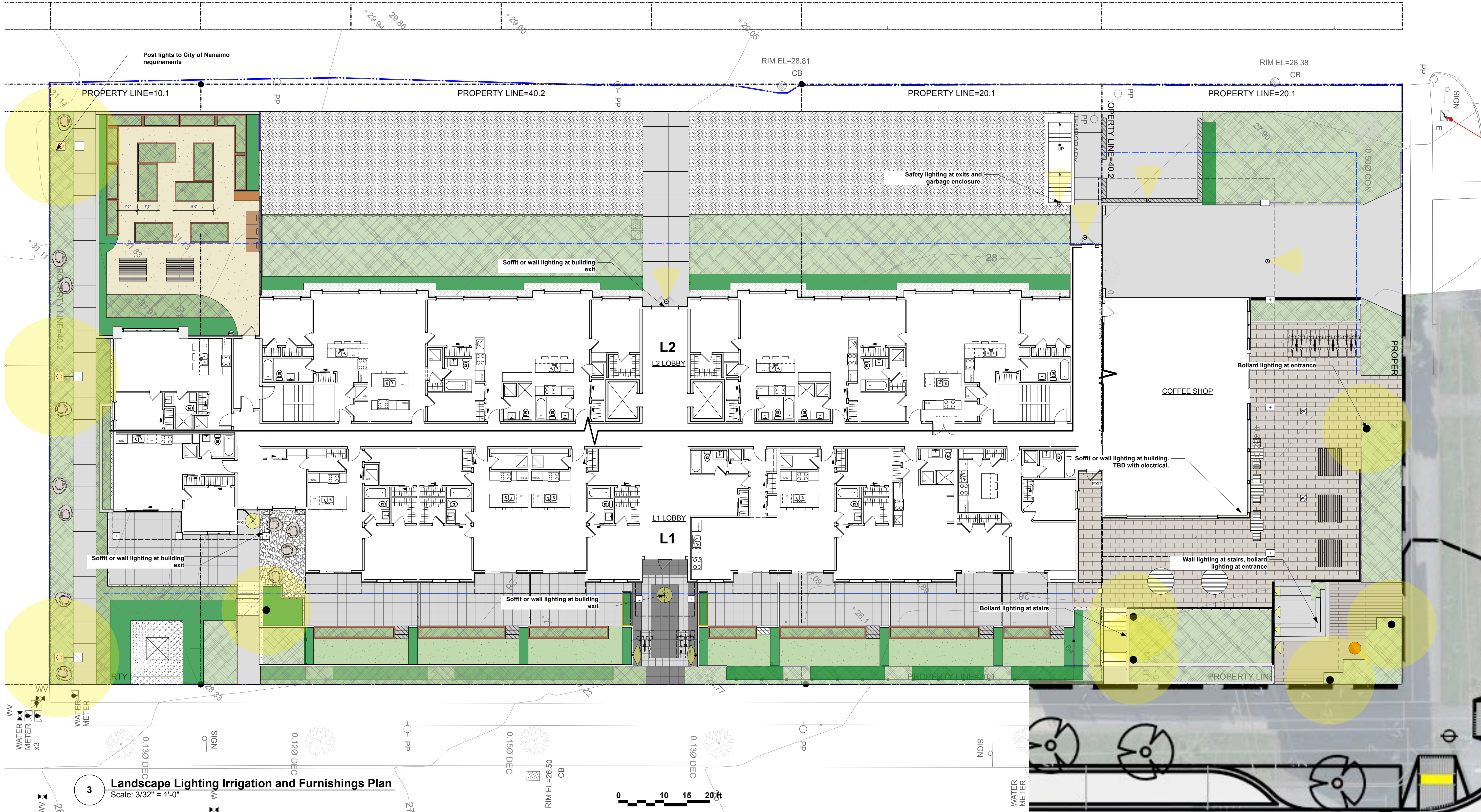

3 Landscape Lighting Irrigation and Furnishings Plan
Scale: 3/32" = 1'-0"

LEGEND

- Property Line**
- Tree protection fence**
- LIGHTING**
- 1 L5c Post Light
- 2 L5c Landscape Bollard Light
- Wall Mount Motion Sensitive Light
Lumark PRV-Prevail LED on wall mount with motion sensor activation
- 3 L5c Wall/ planter/ step light
- IRRIGATION**
- Hose bib
- approx. location of 1" irrigation water stub out, c/w electrical pull, locations to be coordinated with mechanical eng. Irrigate all planters. Note: Irrigation time clock and solenoids location TBC with mech. eng. 2" dia. sch. 40 sleeving below paths, paving, and PIP planter walls where required typ.

RECEIVED
DP1389
2025-JUN-19
Current Planning

2025-06-12 Issue for Review

2025-05-14 Issue for Review

Date Issue Notes

Seal

Prospect & Refuge

LANDSCAPE ARCHITECTS

Building on 25 years of history as Jonathan Loeve, Ltd.

416 W Pender St. | Vancouver, BC | V6B 1T5

t: 604-669-1003 | e: info@prospectrefuge.ca | w: prospectrefuge.ca

Project Title and Address

FRONTIER
102-118 Haliburton St
Nanaimo, BC

First Nations Territory

Snuneymuxw First Nation

Sheet Title

Landscape Lighting Plan

Project No.	Scale
2025-03	As noted
Project Manager	Sheet No.
Reviewed By	L2d
AS	

NOTE: The purpose of this lighting plan is to illustrate conceptual design intent. Further design development is required prior to tender and construction to ensure sufficient illumination. Coordination with Electrical is required. Lighting specs are "or approved alternatives"



3 Planting Plan South
Scale: 1/8" = 1'-0"

LANDSCAPE PLANTING NOTES

1. All planting materials and execution shall conform to the current edition of the Canadian Landscape Standard (CLS) as a minimum acceptable standard.
2. Plant material shall be sourced from Washington State and BC.
3. Landscape Contractor shall submit a soil report with analysis for each soil type specified on site (including all imported soil and existing soil intended for re-use), to Landscape Consultant for approval prior to soil delivery to site. Soil report shall be dated no more than one month before submittal. Soil report shall include CLS measures of soil quality per specified soil type and recommendations for amendment.
4. Landscape Contractor shall amend approved soils per instruction of soil report. Provide documentation of fertilizer and lime applications and rates during the installation and maintenance periods.
5. The prepared sub-grade shall be approved by the Consultant prior to application of top soil mixtures and finish grading. Compacted subgrades shall be scarified to a minimum depth of 6" (150mm) immediately before placing growing medium.
6. The Landscape Contractor shall report discrepancies between plant quantities in the plant list and plan to the Landscape Consultant prior to ordering plant material. Where there is a discrepancy the plan shall supersede the list.
7. All plant material, sod and seeds shall be approved by Landscape Consultant prior to delivery on site. The Landscape Contractor shall provide photographs with scale reference for trees and location information for container stock to the Landscape Consultant prior to the Landscape Consultant scheduling a field inspection. The Landscape Contractor shall provide cut sheets or samples of sod and seeds for approval. Plant material, sod and seeds rejected on site shall be replaced by the Landscape Contractor at no cost to the Owner.
8. Plant material, sod and seed substitutions shall not be made without the written approval of the Landscape Consultant.
9. All plant material (including root balls) shall be free of pernicious weeds, sod, disease, infestation and infection. Plant material shall be supplied by nurseries who are certified by the Clean Plants program, Canadian Nursery Certification Institute (CNCI), current certification standard <http://cleanplants.ca/>. Non-conforming plant material provided by the Landscape Contractor shall be removed, disposed of and replaced at the Landscape Contractor's expense.
10. If obstructions or other conditions detrimental to healthy plant growth are encountered, the Landscape Contractor shall notify the Landscape Consultant and request additional instructions.
11. The exact location of trees shall be determined on site and field fit as required. The Landscape Consultant shall approve the final location of trees prior to planting.
12. Plants shall not be pruned prior to delivery unless otherwise noted by the Landscape Consultant.
13. Install composted organic mulch to CLS standard on all shrub beds after planting and rake smooth. Follow CLS standards for depth and installation.
14. The Landscape Contractor shall provide level 1 maintenance per CLS standard for landscape type and a guarantee for all plant material, for 1 year after the date of substantial completion. Plants installed prior to June (Between Jan 1 and June 1) shall be under extended warranty until June 1 of the following year.
15. Offsite planting shall have landowner approval (municipal or otherwise) prior to installation. Size, species, installation method and location require landowner approval at the time of installation. Offsite plant material and installation shall conform to all Municipal requirements.
16. All landscaping shall have a high efficiency irrigation system to IIABC standards. Unless otherwise specified, the irrigation system shall be design-built by the Irrigation Contractor. The Irrigation Contractor shall provide shop drawings for Landscape Consultant approval.

LANDSCAPE TREE NOTES

1. All landscape construction activities have a high potential for causing damage to trees, roots and soil. The Landscape Contractor shall coordinate with the project Arborist prior to the start of landscape operations to avoid tree protection non-compliance and bylaw issues.
2. Install temporary tree protection fencing as per arborist report or tree protection plan. Maintain the fencing during construction. No storage of materials or equipment, or any other activities are allowed within the protection zone during construction.
3. Removal of the tree barriers requires advance coordination and approval by the project arbor

PLANT LIST					
ID	Latin Name	Common Name	Quantity	Scheduled Size	Notes
TREES					
Ac	Acer circinatum	Vine maple	10	3.0 m ht.	B & B
Am-Al	Amelanchier alnifolia	Saskatoon Berry	2	2m ht.	B & B
Ca	Cedrus atlantica	Atlas Cedar	2	3.0 m ht.	B & B
Cc	Cercis canadensis	Eastern Redbud	1	3.0m ht.	B & B
Ccc	Cercis canadensis 'Covey'	Eastern Redbud	3	1.5m ht.	B & B
Gt	Gleditsia triacanthos 'Honey Locust'	Gleditsia 'Honey Locust'	4	6cm cal	B & B
MG	Magnoia Galaxy	Galaxy Magnolia	4	6 cm cal.	B & B
Po	Picea omorika	Serbian Spruce	2	2 M ht.	B & B
Sp	Stewartia pseudocamellia	Japanese Stewartia	3	6 cm cal	B & B
SHRUBS					
Auu	Arctostaphylos uva-ursi	Kinnikinnick	780	#1 pot @ 1'-0" oc	Cont.
Fc	Fragaria chiloensis	Beach Strawberry	26	4" pot @ 1'-0" oc	Cont.
H Aur	Hakonechloa macra 'Aureola'	Golden Japanese Forest Grass	110	#1 pot	Cont.
S-HxJ	Hamamelis x intermedia 'Jelena'		7	#3 pot	Cont.
Heu	Heuchera spp.	Coral Bells	18	#1 pot	Cont.
Lp	Lonicera pileata	Privet Honeysuckle	127	#1 pot @ 2'-6" oc	Cont.
Mr	Mahonia repens	Creeping Oregon Grape	269	#1 pot @ 2'-6" oc	Cont.
PmP	Pinus mugo 'Pumilo'	Pumilo Mugo Pine	30	#3 pot @ 3'-0" oc	Cont.
Pm	Polystichum munitum	Sword Fern	468	#1 pot @ 2'-0" oc	Cont.
Ra	Ribes sanguineum	Red Flowering Currant	9	#2 pot	Cont.
Rn	Rosa nutkana	Nootka Rose	8	#2 pot	Cont.
Sh	Sarcococca hookerana	Sweet Box	192	#3 pot	Cont.
SAJ	Sedum 'Autumn Joy'	Autumn Joy Stonecrop	12	#1 pot @ 1'-6" oc	Cont.
Sjmm	Skimmia japonica 'Magic Merlot'	Magic Merlot Skimmia	16	#3 pot	Cont., (Male & Female)
Sa	Symphoricarpos albus	Snowberry	20	#3 pot @ 3'-6" oc	Cont.
Txm	Taxus x media 'Hillsii'	Hills Yew	66	1.25 m ht	B&B
VoT	Vaccinium ovatum 'Thunderbird'	Thunderbird Evergreen Huckleberry	197	#3 pot @ 2'-6" oc	Cont.
GROUND COVER					
Assorted perennials selected by Landscape Architect			25	#1 pot	Cont.

RECEIVED
DP1389
2025-JUN-19
Current Planning

2025-06-12

Issue for Review

2025-05-14

Issue for Review

Date

Issue Notes

Seal

Prospect & Refuge
LANDSCAPE ARCHITECTS
Building on 25 years of history as Jonathan Loeve, Ltd.
416 W Pender St | Vancouver, BC | V6B 1T5
t: 604-669-1003 | e: info@prospectrefuge.ca | w: prospectrefuge.ca

Project Title and Address

FRONTIER
102-118 Haliburton St
Nanaimo, BC

First Nations Territory

Snuneymuxw First Nation

Sheet Title

Landscape Planting Plan

Project No.

2025-03

Scale

As noted

Project Manager

AS

Sheet No.

L3a

1. All planting materials and execution shall conform to the current edition of the Canadian Landscape Standard (CLS) as a minimum acceptable standard.
2. Plant material shall be sourced from Washington State and BC.
3. Landscape Contractor shall submit a soil report with analysis for each soil type specified in site (including all imported soil and existing soil intended for re-use), to Landscape Consultant for approval prior to soil delivery to site. Soil report shall be dated no more than one month before submittal. Soil report shall include CLS measures of soil quality per specified soil type and recommendations for amendment.
4. Landscape Contractor shall amend approved soils per instruction of soil report. Provide documentation of fertilizer and lime applications and rates during the installation and maintenance periods.
5. The prepared sub-grade shall be approved by the Consultant prior to application of top soil mixtures and finish grading. Compacted subgrades shall be scarified to a depth of 6" (150mm) immediately before placing growing medium.
6. The Landscape Contractor shall report discrepancies between plant quantities in the plant list and plan to the Landscape Consultant prior to ordering plant material. Where there is a discrepancy the plan shall supersede the list.
7. All plant material, sod and seeds shall be approved by Landscape Consultant prior to delivery on site. The Landscape Contractor shall provide photographs with scale reference for trees and location information for container stock to the Landscape Consultant prior to the Landscape Consultant scheduling a field inspection. The Landscape Contractor shall provide cutsheets or samples of sod and seeds for approval. Plant material, sod and seeds rejected on site shall be removed by the Landscape Contractor at no cost to the Owner.

8. Plant material, sod and seed substitutions shall not be made without the written approval of the Landscape Consultant.

9. All plant material (including root balls) shall be free of pernicious weeds, sod, disease, infestation and infection. Plant material shall be supplied by nurseries who are certified by the Clean Plants program, Canadian Nursery Certification Institute (CNCI), current certification standard <http://cleanplants.ca/>. Non-conforming plant material provided by the Landscape Contractor shall be removed, disposed of and replaced at the Landscape Contractor's expense.

10. If obstructions or other conditions detrimental to healthy plant growth are encountered, the Landscape Contractor shall notify the Landscape Consultant and request additional instructions.

11. The exact location of trees shall be determined on site and field fit as required. The Landscape Consultant shall approve the final location of trees prior to planting.

12. Plants shall not be pruned prior to delivery unless otherwise noted by the Landscape Consultant

13. Install composted organic mulch to CLS standard on all shrub beds after planting and rake smooth. Follow CLS standards for depth and installation.

14. The Landscape Contractor shall provide level 1 maintenance per CLS standard for landscape type and a guarantee for all plant material, for 1 year after the date of substantial completion. Plants installed prior to June (Between Jan 1 and June 1) shall be under extended warranty until June 1 of the following year.

15. Offsite planting shall have landowner approval (municipal or otherwise) prior to installation. Size, species, installation method and location require landowner approval at the time of installation. Offsite plant material and installation shall conform to all Municipal requirements.

16. All landscaping shall have a high efficiency irrigation system to IABC standards. Unless otherwise specified, the irrigation system shall be design-built by the Irrigation Contractor. The Irrigation Contractor shall provide shop drawings for Landscape Consultant approval.

1. All landscape construction activities have a high potential for causing damage to trees, roots and soil. The Landscape Contractor shall coordinate with the project Arborist prior to the start of landscape operations to avoid tree protection non-compliance and bylaw issues.
2. Install temporary tree protection fencing as per arborist report or tree protection plan. Maintain the fencing during construction. No storage of materials or equipment, or any other activities are allowed within the protection zone during construction.
3. Removal of the tree barriers requires advance coordination and approval by the project arborist

RECEIVED
DP1389
2025-JUN-19
Current Planning

2025-06-12	Issue for Review
2025-05-14	Issue for Review
Date	Issue Notes

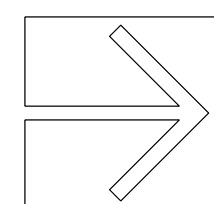

LANDSCAPE ARCHITECTS

Building on 25 years of history as Jonathan Losee, Ltd.

416 W Pender St. | Vancouver, BC | V6B 1T5

416 W Pender St. | Vancouver, BC | V6B 1T5
t: 604-669-1003 | e: info@prospectrefuge.ca | w: prospectrefuge.ca

Project Title and Address

FRONTIER
102-118 Haliburton St
Nanaimo, BC

First Nations Territory

Snuneymuxw First Nation

Sheet Title

Landscape Planting Plan

Project No.	Scale
2025-03	As noted
Project Manager	Sheet No.
Reviewed By	L3b
AS	

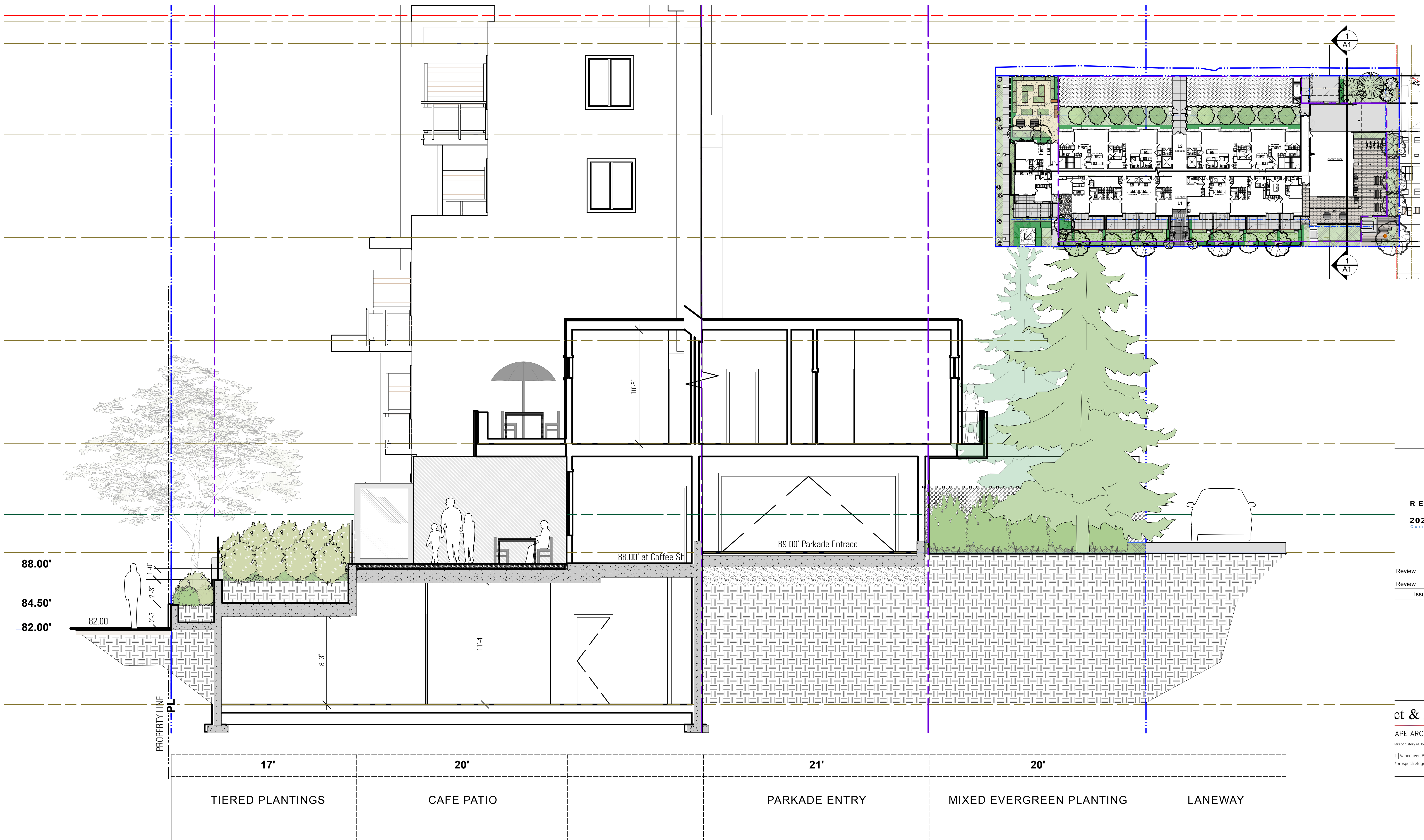

2 Section looking South
Scale: 1/4" = 1'-0"



RECEIVED
DP1389
2025-JUN-19
Current Planning

Review
Review
Issue Notes

ct & Refuge
APE ARCHITECTS
vers of history as Jonathan Loeve, Ltd.
t | Vancouver, BC | V6B 1T5
Prospectrefuge.ca | w: prospectrefuge.ca

S
ale
As noted
est No.
0
L4

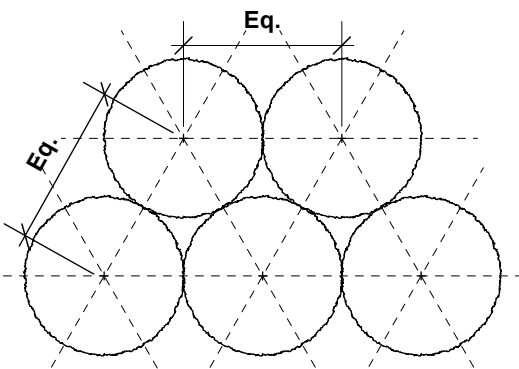

Plan view of typical planting layout: Unless otherwise noted, plants are to be spaced equally, in triangular layout pattern, to specified on-centre distance. Refer to planting plan and schedule.

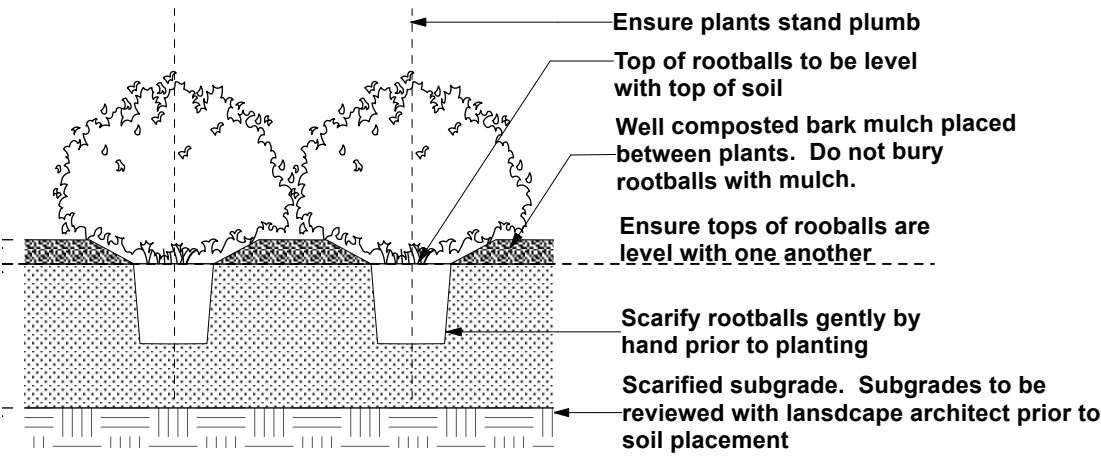

- NOTES:
1. Min. container size and root spread to comply with BC Landscape Standard for Nursery Stock - current edition.
 2. Prune all damaged, diseased, and dead limbs.
 3. Keep roots moist during installation: water container stock well prior to planting and following planting.

1 Shrub and Perennial Planting on Grade

Scale: 1/2" = 1'-0"

- Notes:
1. Supply soil sample and analysis to landscape architect for approval
 2. Soil depths to meet or exceed Canadian Landscape Standard for growing medium in their context.
 3. Soil depths to be confirmed and approved by Landscape Architect and when on-slab additionally by Structural Engineer, prior to installation.

Standard Growing Medium: Level 1 type 1P as per Canadian Landscape Standards unless otherwise noted.

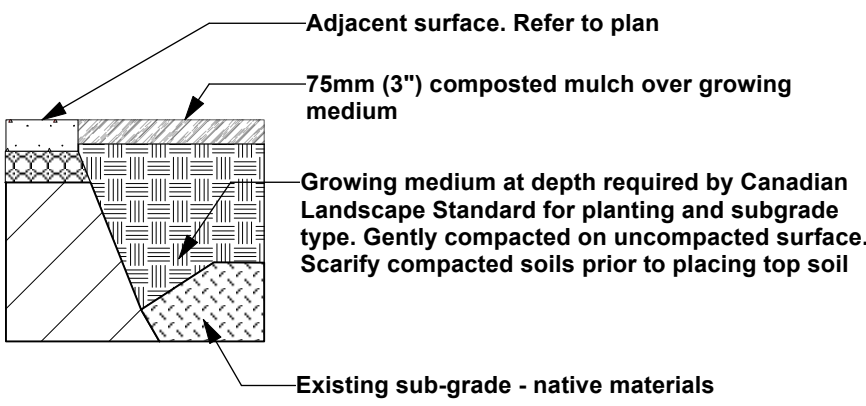

5 Growing medium on grade

Scale: 1/2" = 1'-0"

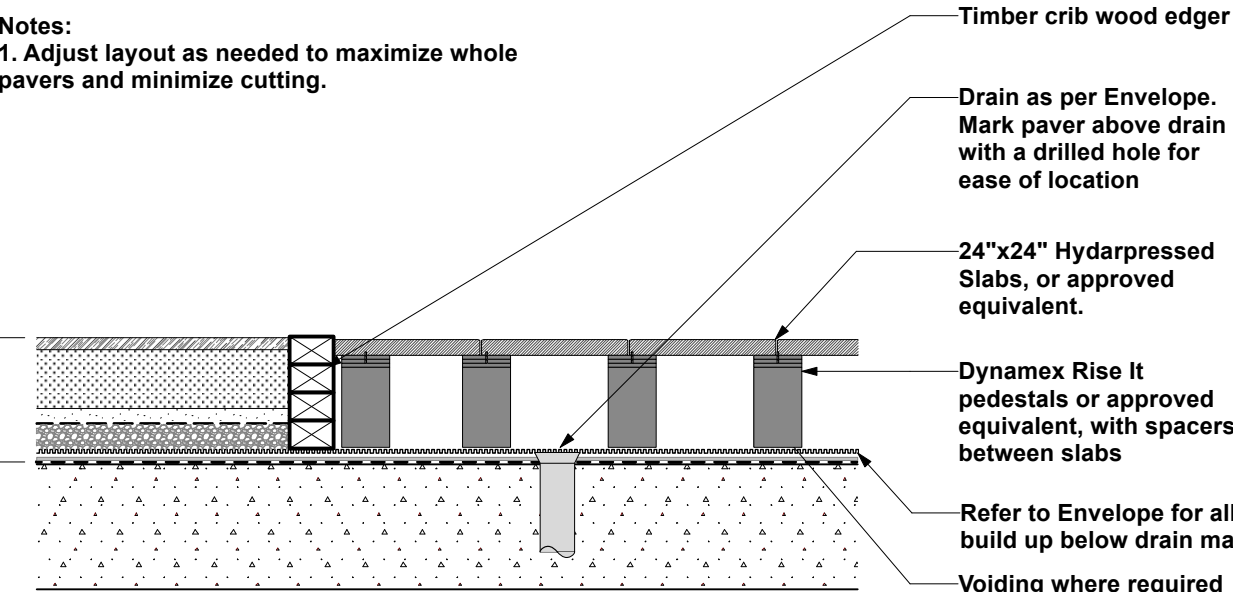

- Notes:
1. Adjust layout as needed to maximize whole pavers and minimize cutting.

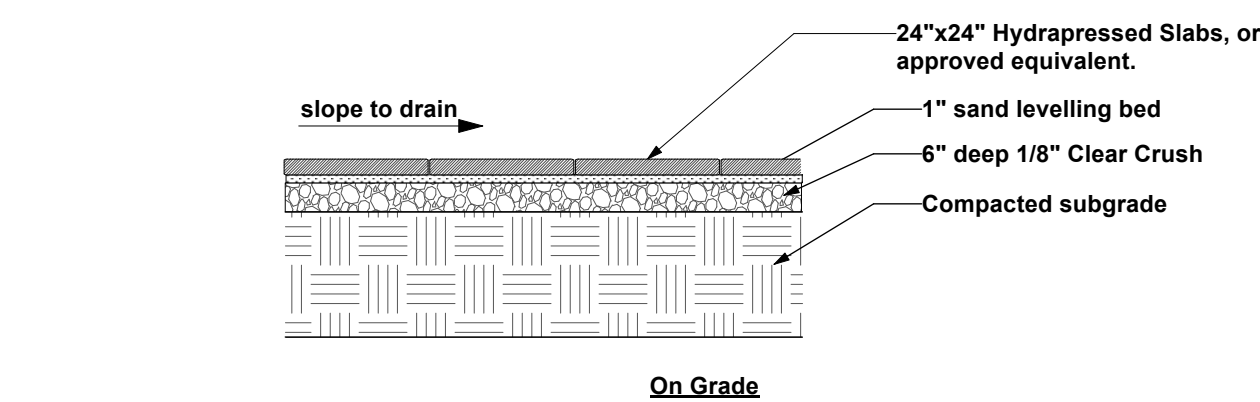

9 Hydrapressed Slabs

Scale: 1/2" = 1'-0"

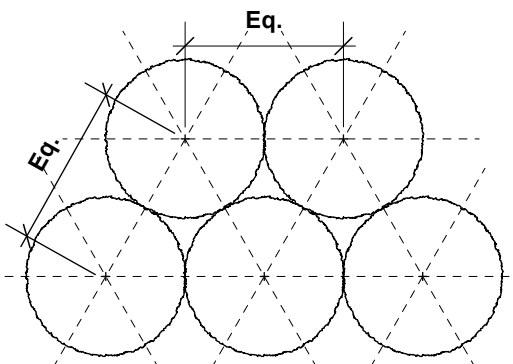

Plan view of typical planting layout: Unless otherwise noted, plants are to be spaced equally, in triangular layout pattern, to specified on-centre distance. Refer to planting plan and schedule.

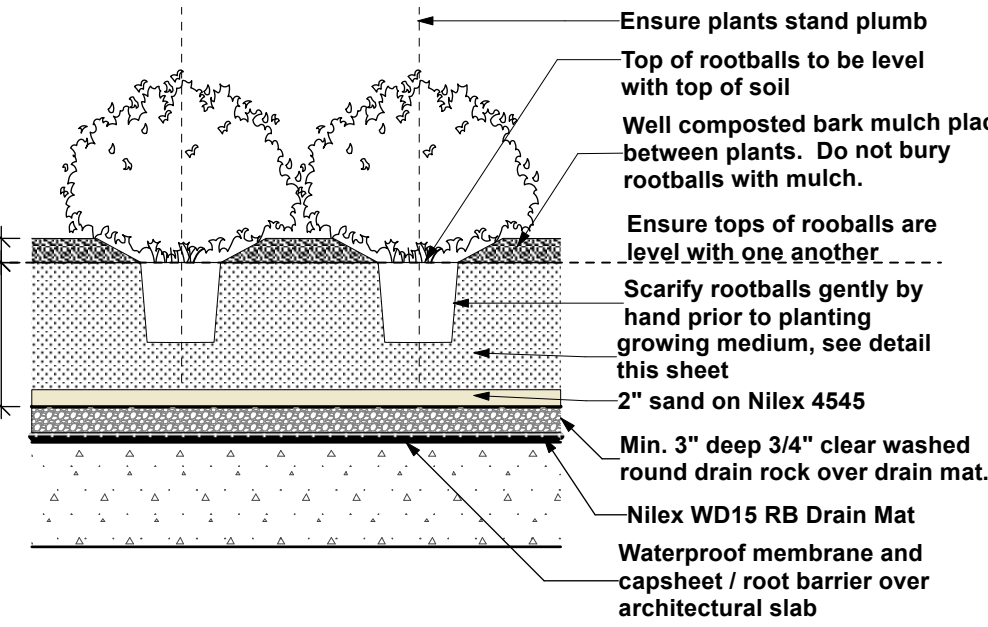

2 Shrub and Perennial Planting on Slab

Scale: 1/2" = 1'-0"

- Notes:
1. See plan for soil depth. Fill all additional depths with light weight voiding.
 2. Supply soil report to Landscape Consultant for approval prior to shipment to site. Soil report shall be dated no more than one month prior to delivery to site, and is to be submitted to Landscape Consultant min. 1 week before installation.
 3. Sand to be Fraser River Pump sand - max 2% fines (silt + clay) with 60-70% medium sieve sand and 15-20% coarse sand 15-20% fine sand content, free of soluble salts. Submit analysis to Landscape Consultant for review prior to shipment to site.

Standard Growing Medium: Level 1 type 1H as per Canadian Landscape Standards unless otherwise noted. Soil for all on slab applications to be a lightweight, free draining planter blend. Fines within soil blend to be less than 15% combined, 70-90% sand, and 14-20% Organic matter as defined in a soil analysis provided to the landscape consultant for review and comment prior to delivery on site.

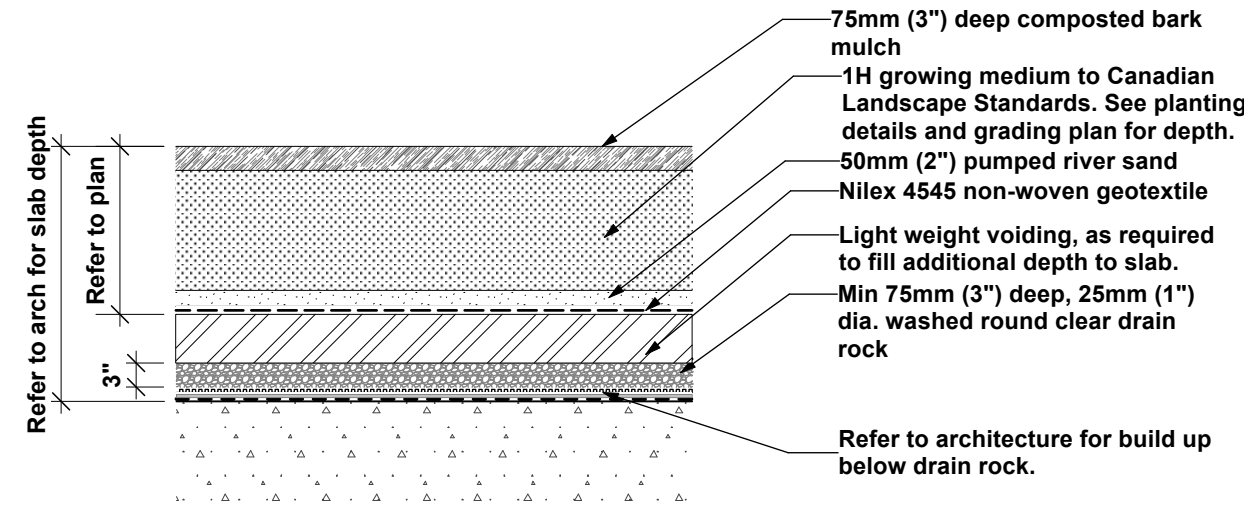

6 Growing medium on Slab

Scale: 1/2" = 1'-0"

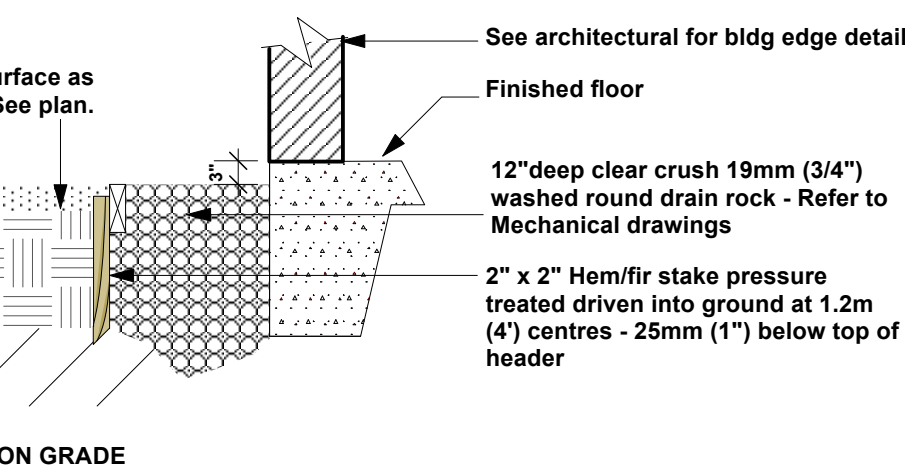
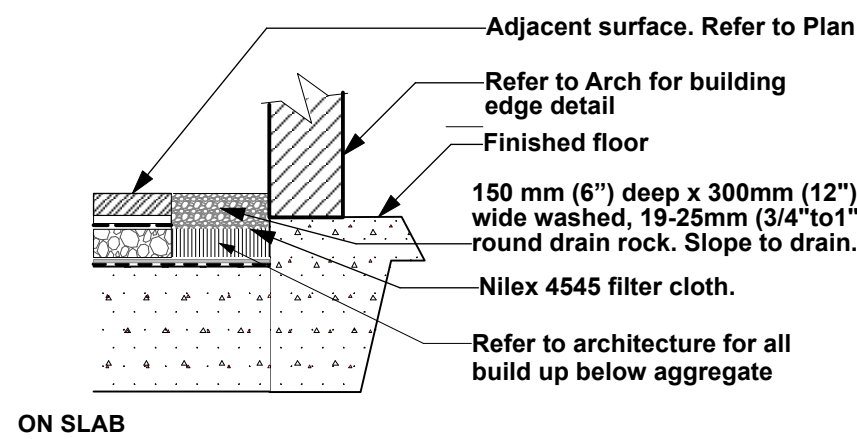

14 Gravel Strip

Scale: 1/2" = 1'-0"

REMOVE ALL NURSERY TIES, STAKES AND LABELS FROM TREES PRIOR TO PLANTING



- NOTES:
1. Do not cut tree leader. Any corrective pruning shall be reviewed with landscape architect.
 2. caliper size and root ball size shall be in accordance with Canadian Landscape Standard.
 3. Selected trees shall be approved by Landscape Architect at the nursery or via photographs with scale reference. Trees rejected on site will be replaced at the contractor's expense.
 4. Keep rootballs well watered on site, before and after planting. Ensure a watering plan is in place to sustain new tree plantings for the duration of warranty period

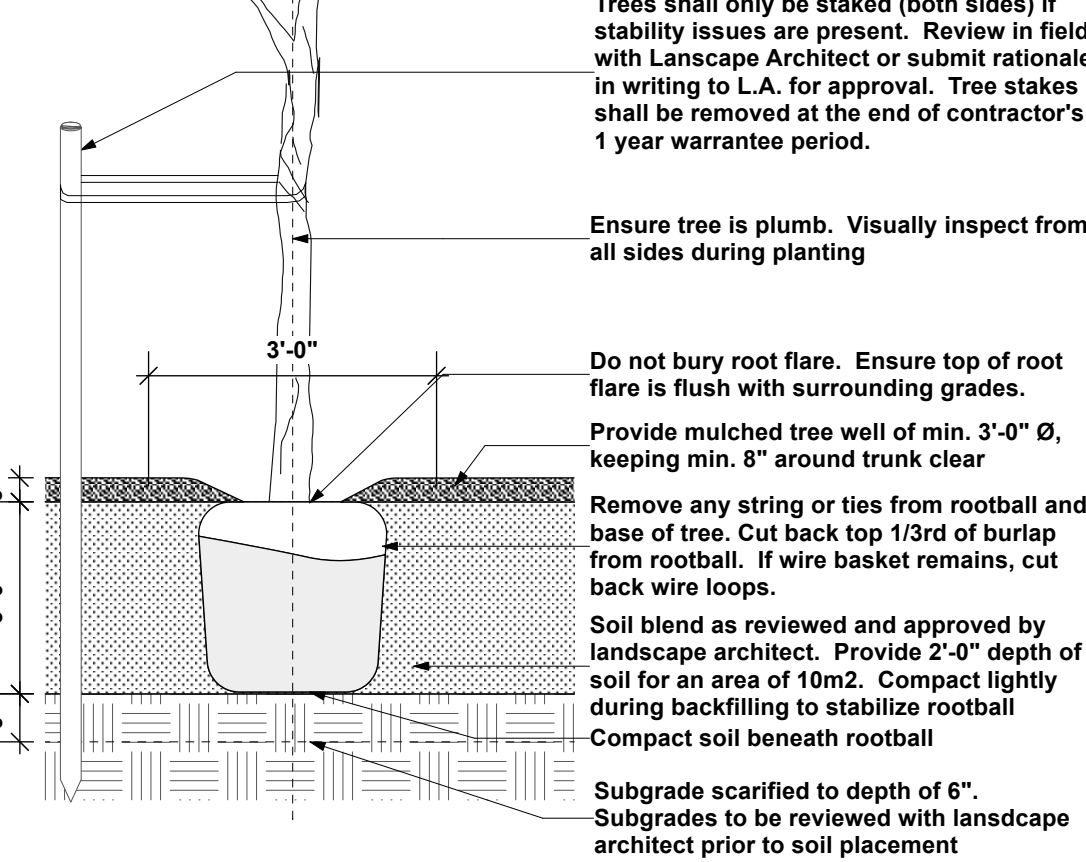

3 Tree Planting on Grade

Scale: 1/2" = 1'-0"

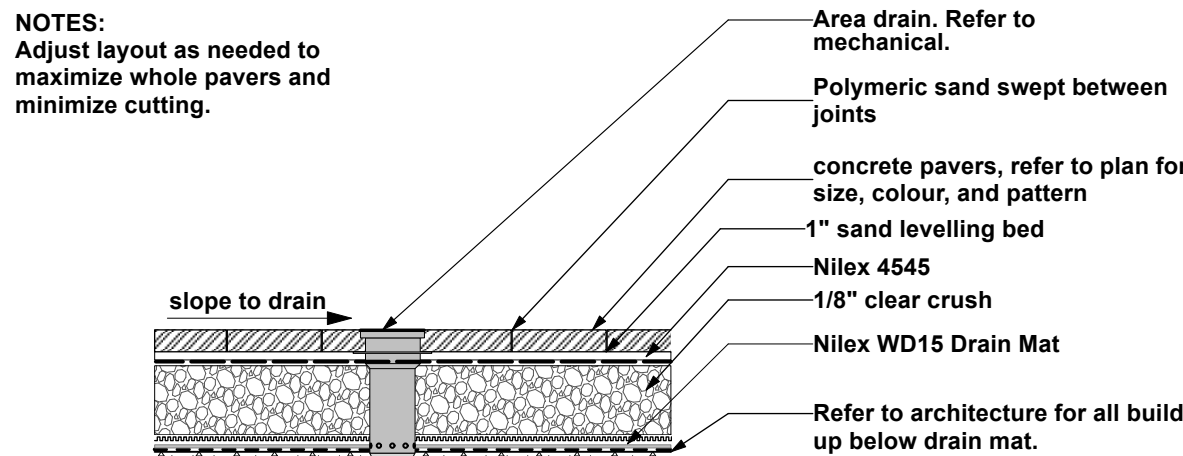

- NOTES:
1. Adjust layout as needed to maximize whole pavers and minimize cutting.

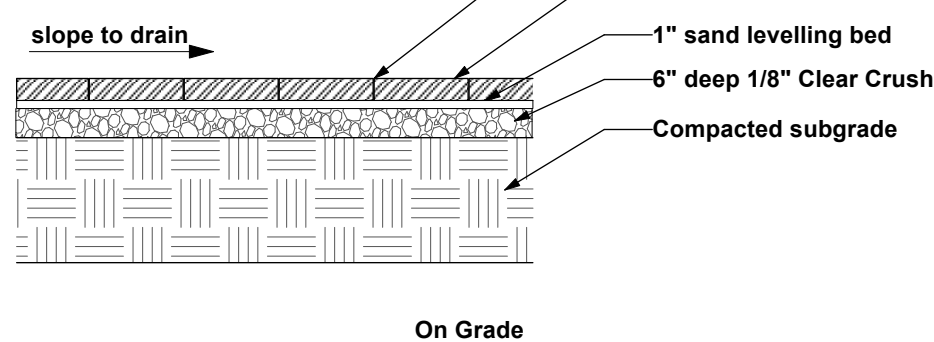

7 Concrete Unit Pavers

Scale: 1/2" = 1'-0"

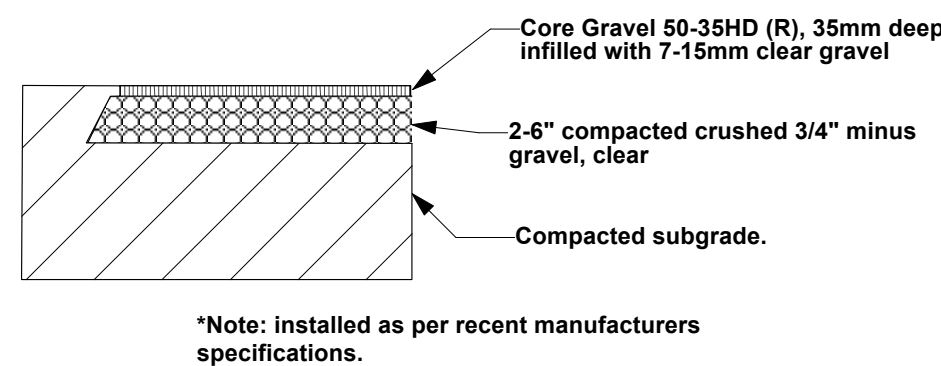
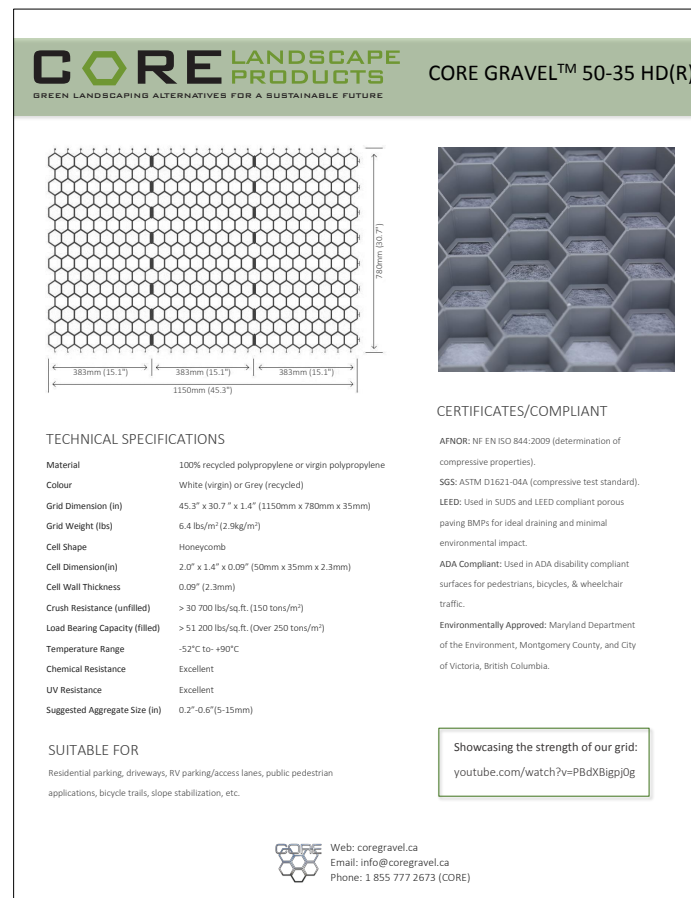

11 Reinforced Gravel Driveway

Scale: 1/2" = 1'-0"

- Notes:
- Control Joints: 1/4" (6mm) wide sawcut to 1/3 depth of slab after firm enough to not cause damage, sawcut joints before random cracking including rebar, coordinate appropriate timing of sawcuts on site.
 - Isolation/Expansion Joints: 1/2" (12mm) max. width isolation/expansion joint with joint filler, max. 9m (30') apart. Layout coordinated in field by contractor
- Contractor to confirm and provide layout of construction and control joints prior to installation

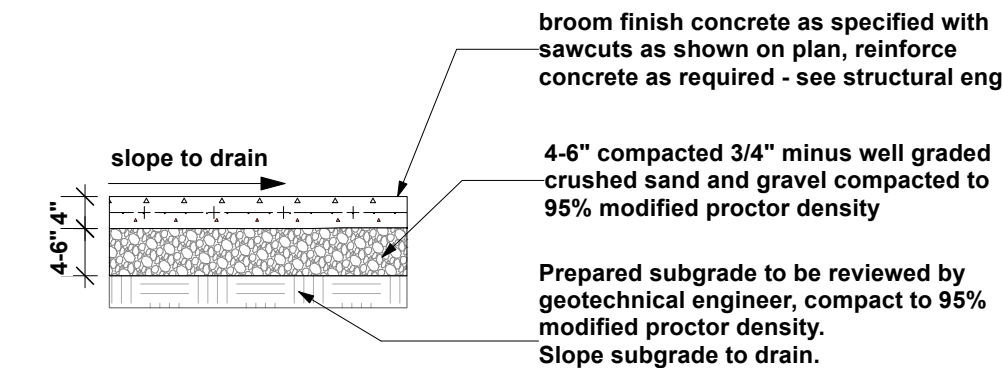

8 CIP Concrete Paving

Scale: 1/2" = 1'-0"

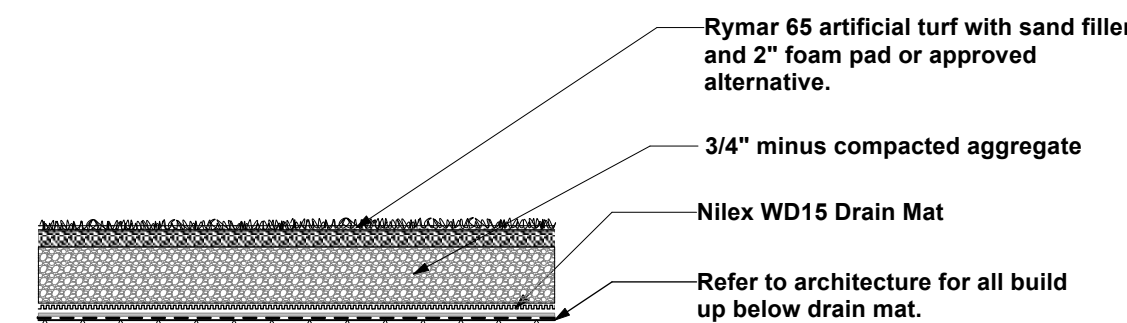

- NOTE:
1. Submit sample of artificial turf, foam pad and filler material to Landscape Consultant for approval.

12 Synthetic Turf on Slab

Scale: 1/2" = 1'-0"

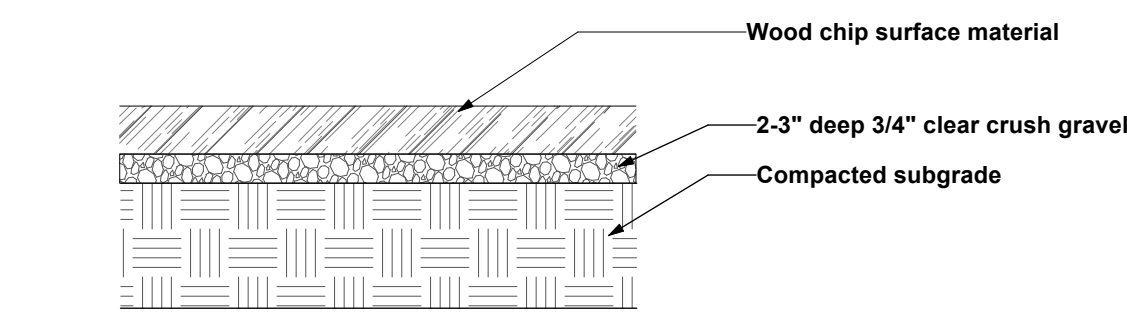

- NOTE:
1. Submit sample of wood chips to Landscape Consultant for approval.

13 Wood Chips on Grade

Scale: 1/2" = 1'-0"

- NOTES:
1. Do not cut tree leader. Any corrective pruning shall be reviewed with landscape architect.
 2. caliper size and root ball size shall be in accordance with Canadian Landscape Standard.
 3. Selected trees shall be approved by Landscape Architect at the nursery or via photographs with scale reference. Trees rejected on site will be replaced at the contractor's expense.
 4. Keep rootballs well watered on site, before and after planting. Ensure a watering plan is in place to sustain new tree plantings for a minimum of 55 days.
 5. Soil for all on slab applications to be a lightweight, free draining planter blend to meet Canadian Landscape Standard soil type 1L. Fines within soil blend to be less than 15%, as defined in a soil analysis provided to the landscape architect for review and comment prior to delivery on site. Soil report shall be no older than one month.

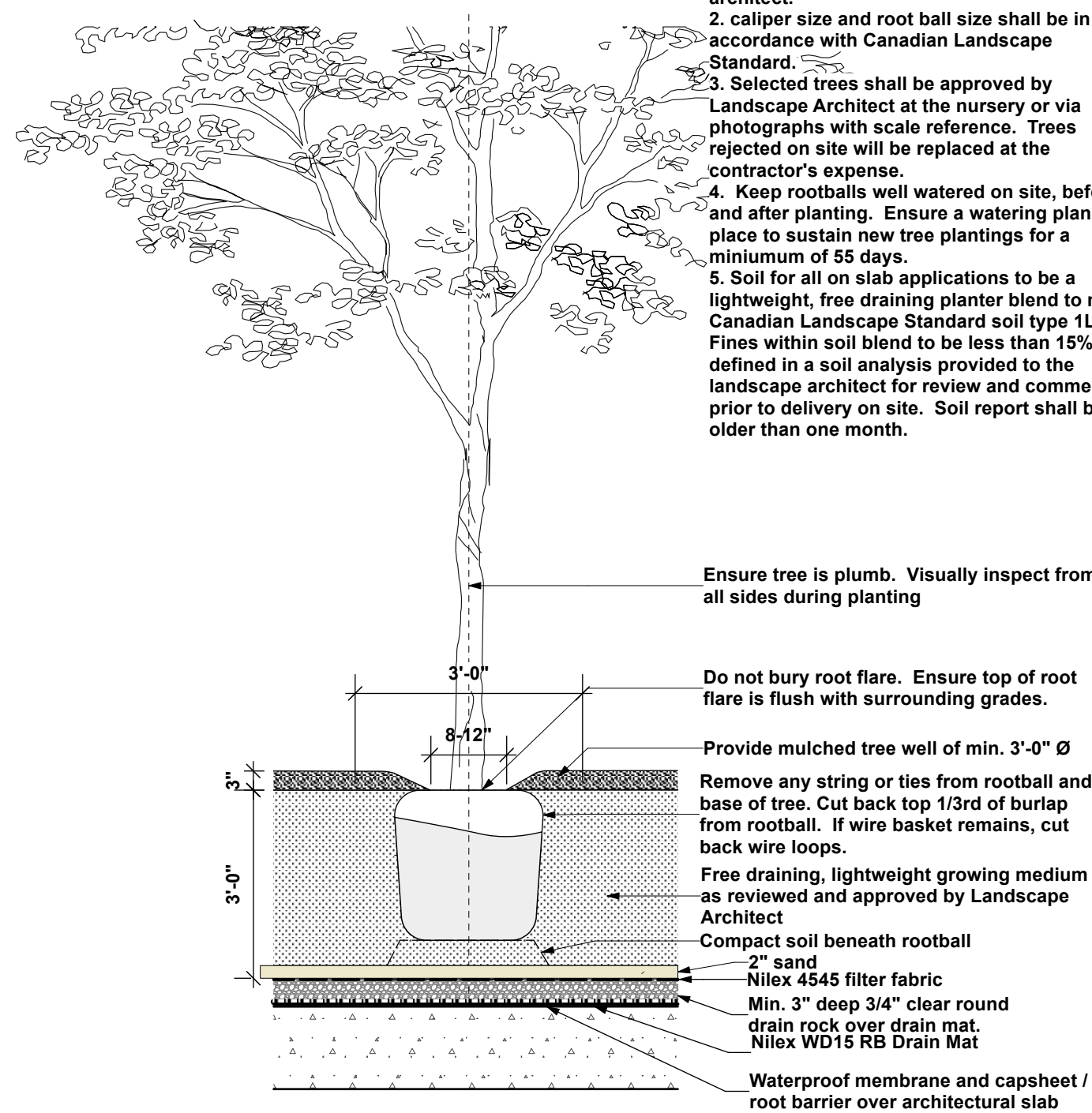

4 Tree Planting on Slab

Scale: 1/2" = 1'-0"

RECEIVED DP1389 2025-JUN-19 Current Planning	
2025-06-12	Issue for Review
2025-05-14	Issue for Review
Date	Issue Notes
Seal	
Prospect & Refuge LANDSCAPE ARCHITECTS Building on 25 years of history as Jonathan Loeve, Ltd. 416 W Pender St. Vancouver, BC V6B 1T5 t: 604-669-1003 e: info@prospectrefuge.ca w: prospectrefuge.ca	
Project Title and Address FRONTIER 102-118 Haliburton St Nanaimo, BC	
First Nations Territory Snuneymuxw First Nation	
Sheet Title Landscape Details	
Project No. 2025-03	Scale As noted
Project Manager	Sheet No. L5a
Reviewed By AS	

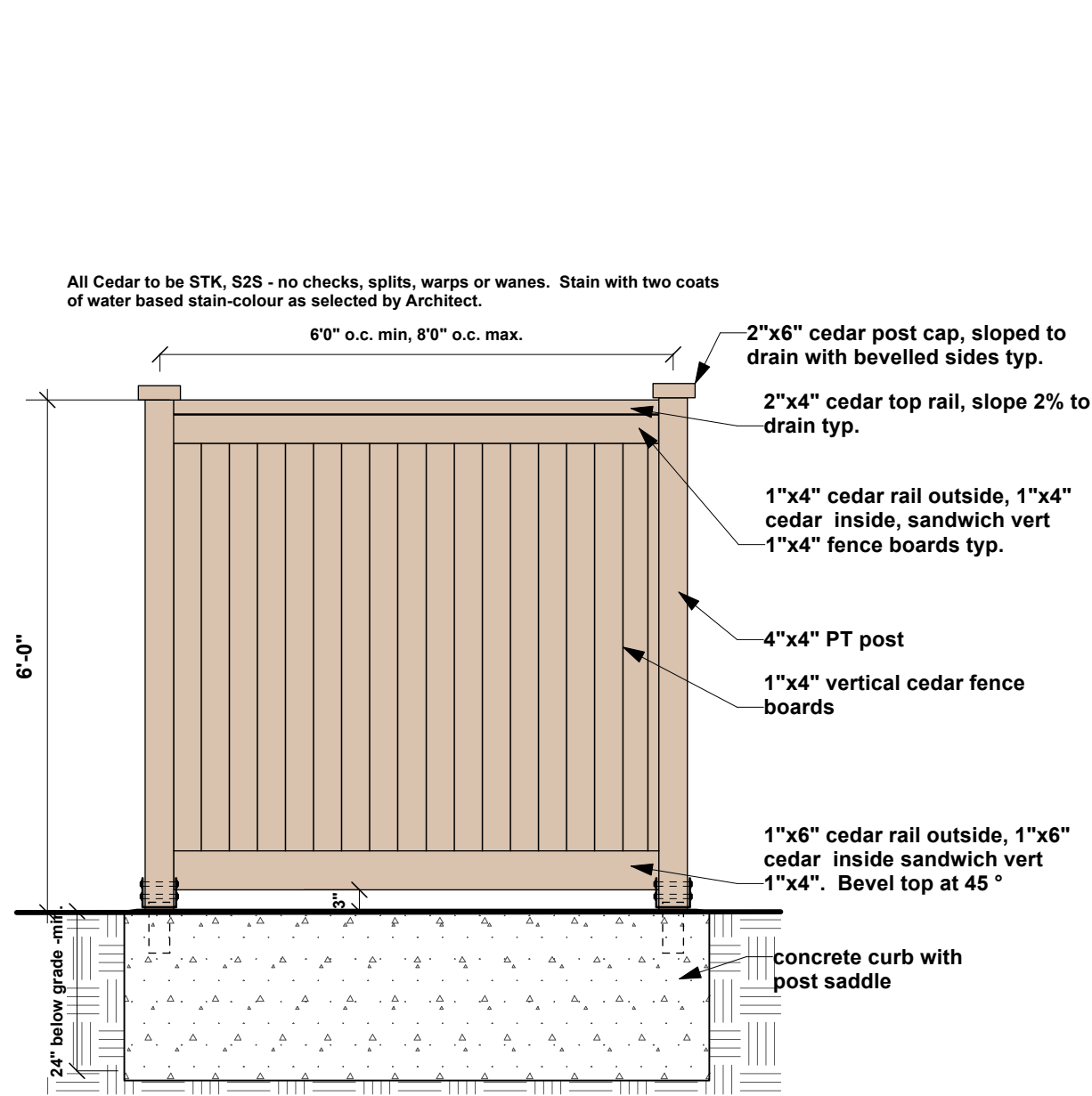

1 **Solid Board Privacy Fence**
Scale: 1/2" = 1'-0"

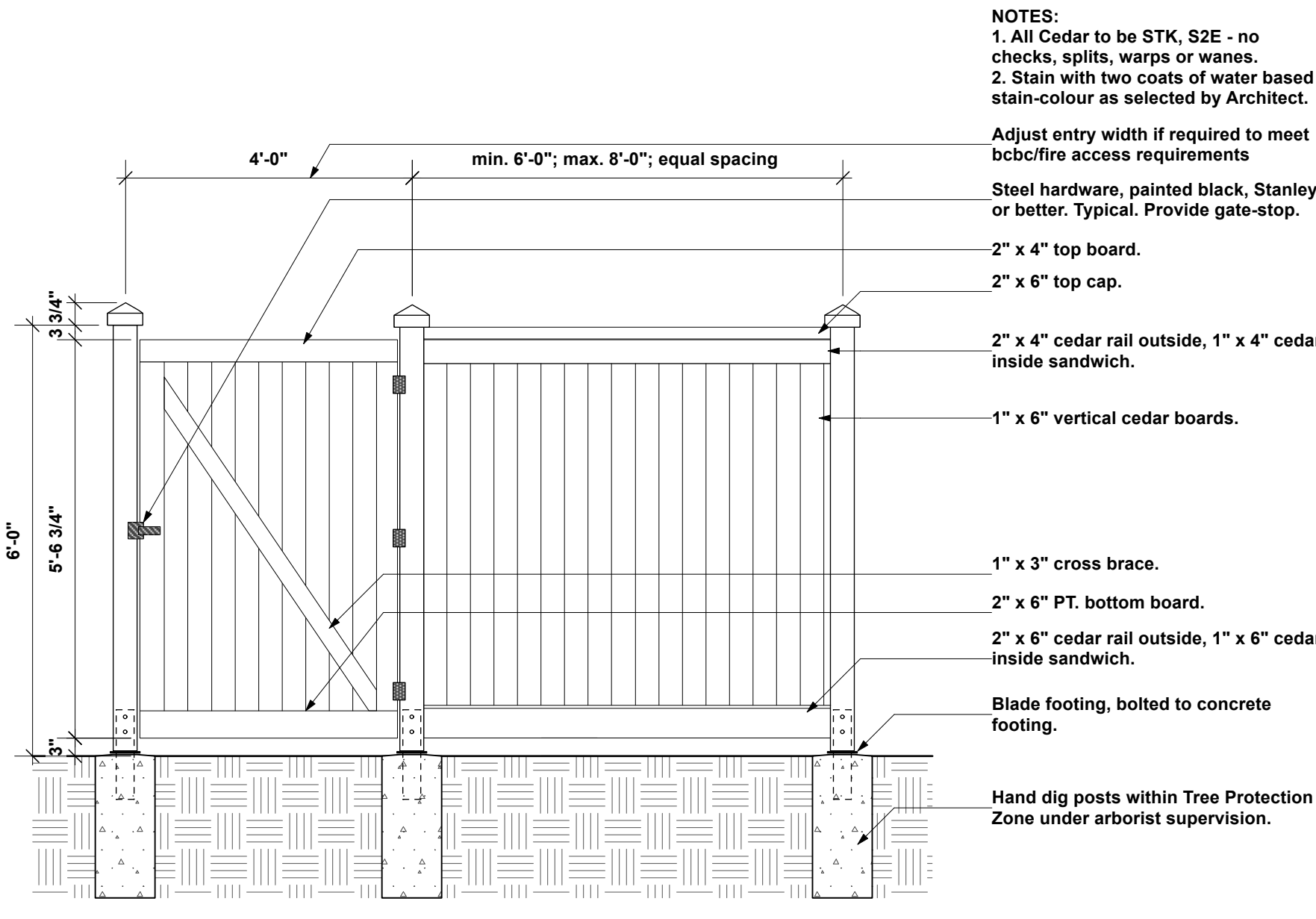

2 **Solid Board Privacy Fence with Gate**
Scale: 1/2" = 1'-0"

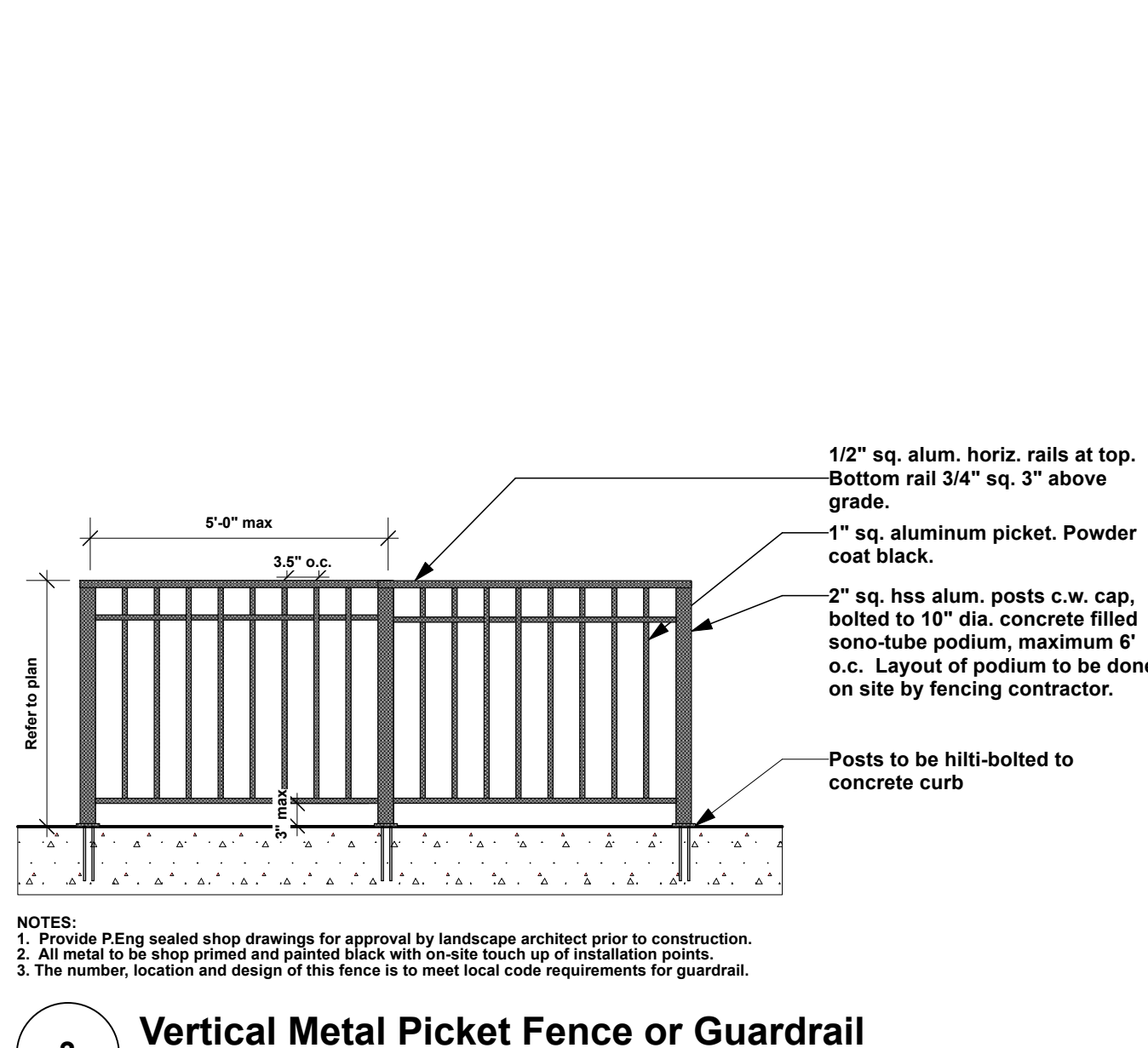

3 **Vertical Metal Picket Fence or Guardrail**
Scale: 1/2" = 1'-0"

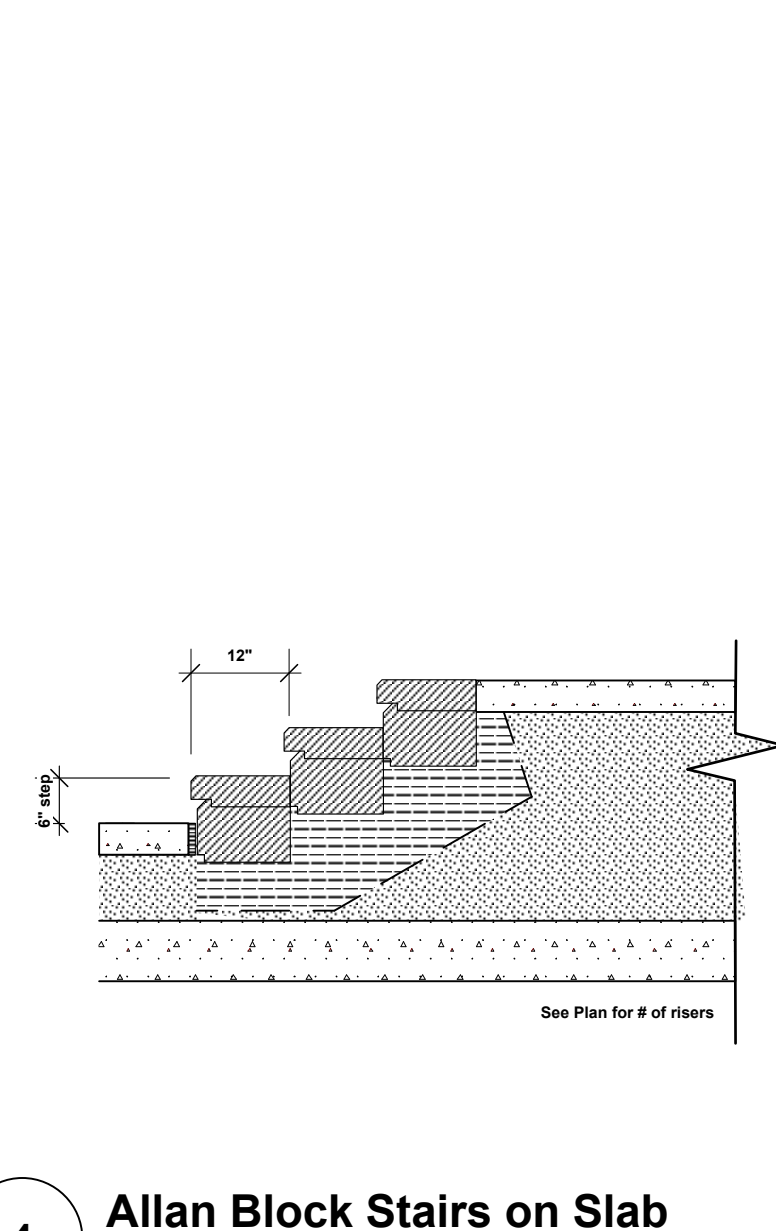

4 **Allan Block Stairs on Slab**
Scale: 1/2" = 1'-0"

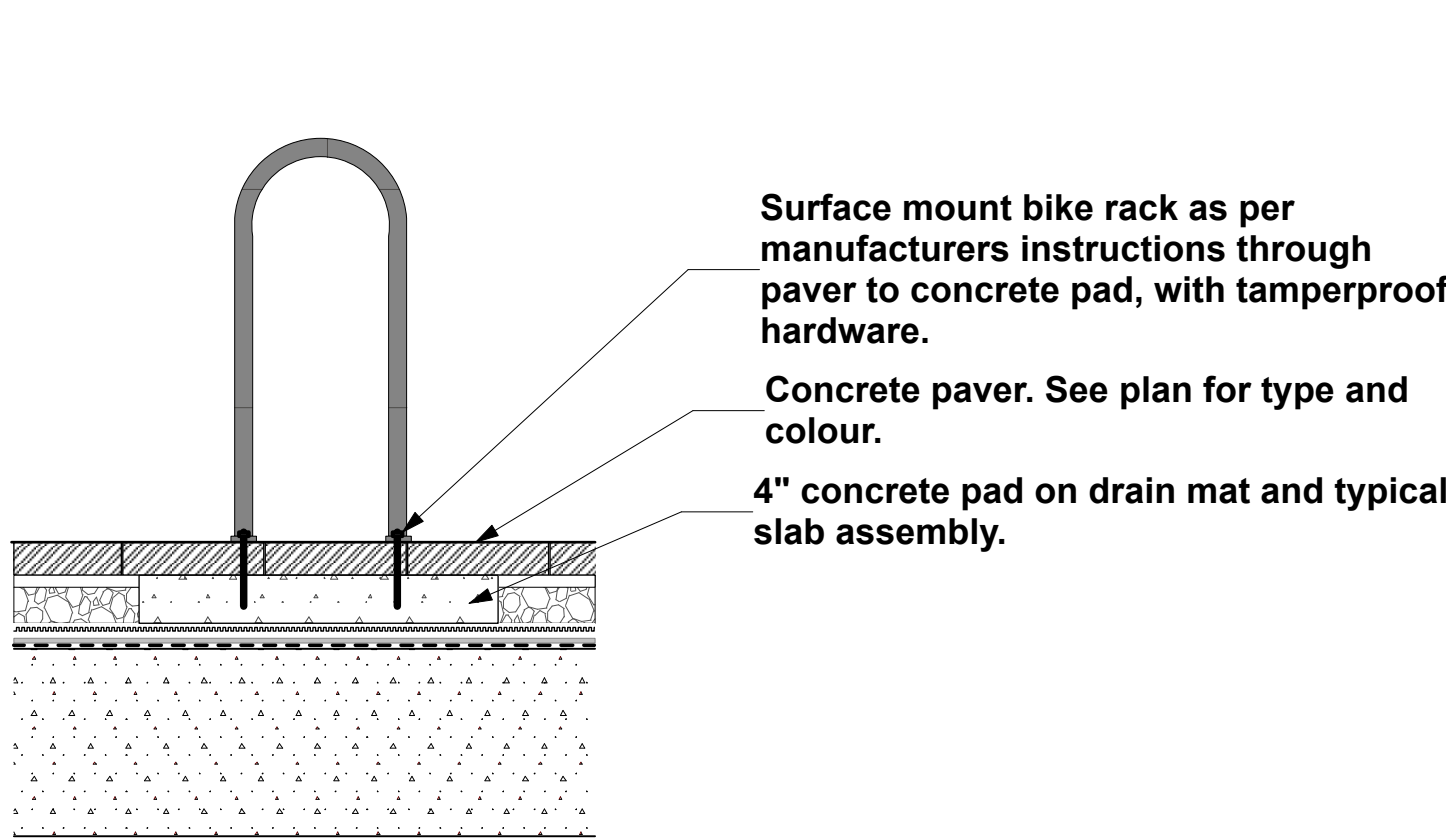

5 **Staple Style Class 'B' Bike Rack**
Scale: 3/4" = 1'-0"

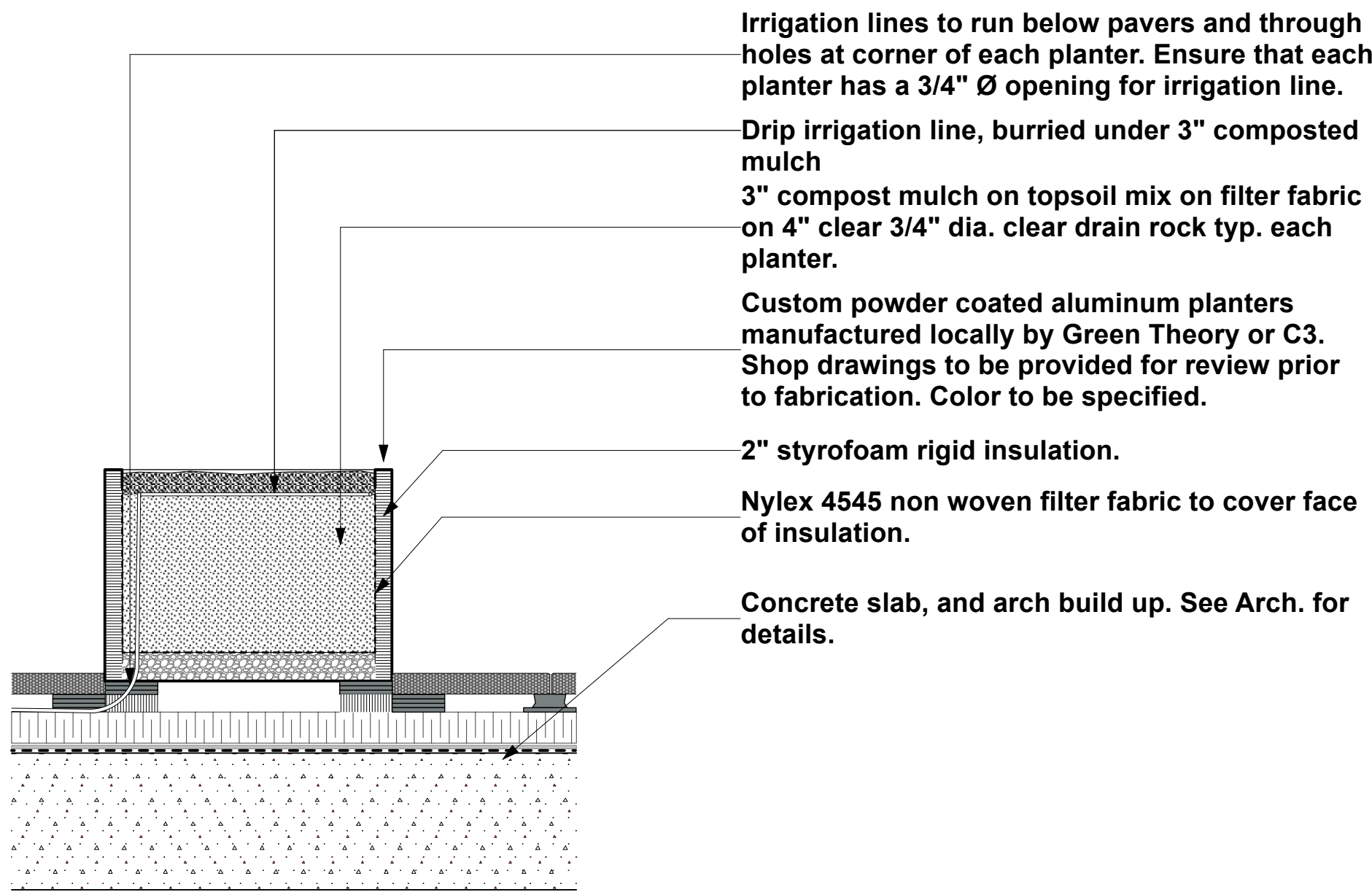

6 **Metal Planter**
Scale: 3/4" = 1'-0"

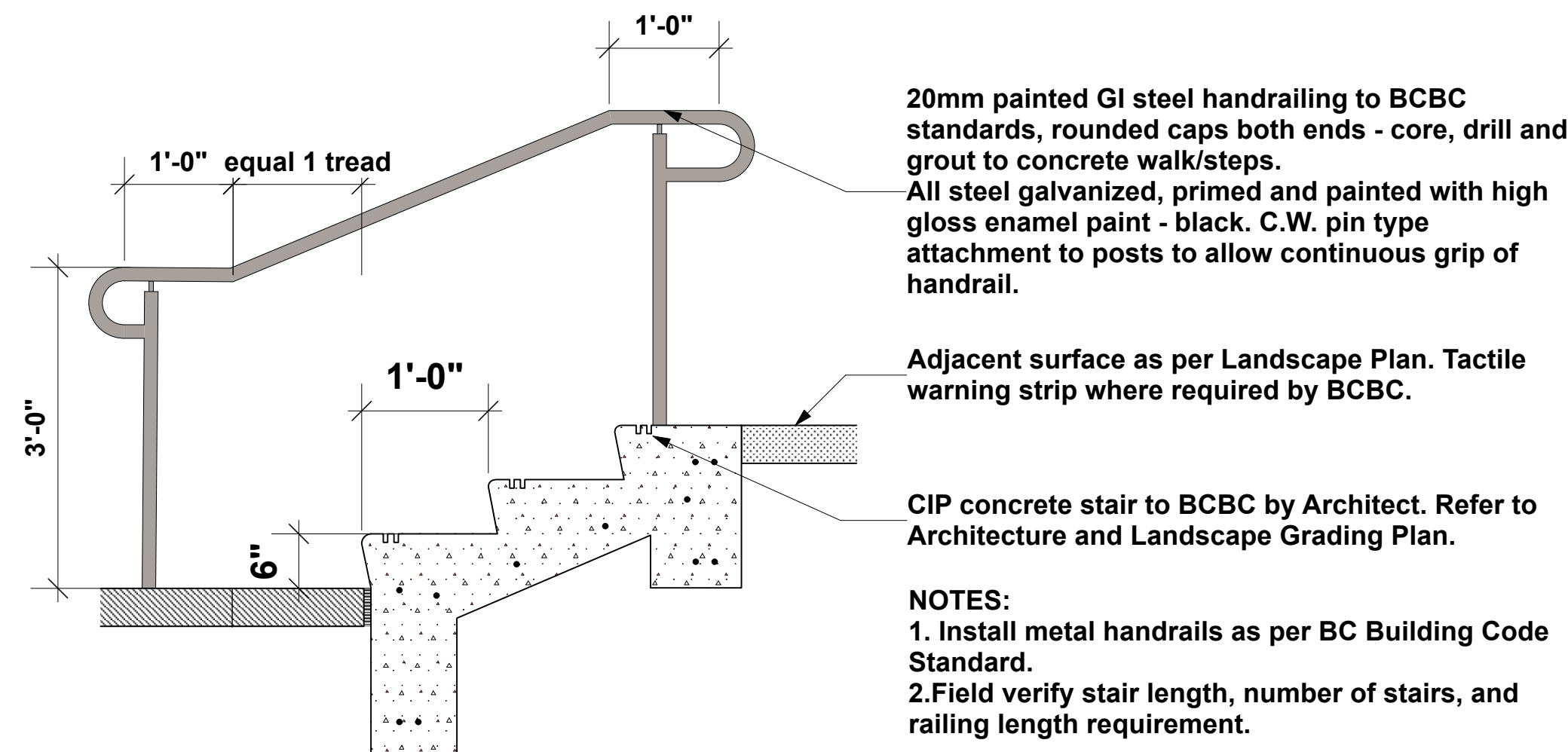

7 **Stair with Handrail**
Scale: 3/4" = 1'-0"

RECEIVED DP1389 2025-JUN-19 Current Planning	
2025-06-12	Issue for Review
2025-05-14	Issue for Review
Date	Issue Notes
Seal	
Prospect & Refuge LANDSCAPE ARCHITECTS Building on 25 years of history as Jonathan Lowe, Ltd. 416 W Pender St. Vancouver, BC V6B 1T5 t: 604-669-1003 e: info@prospectrefuge.ca w: prospectrefuge.ca	
Project Title and Address FRONTIER 102-118 Haliburton St Nanaimo, BC	
First Nations Territory Snuneymuxw First Nation	
Sheet Title Landscape Details	
Project No. 2025-03	Scale As noted
Project Manager	Sheet No. L5b
Reviewed By AS	

Project	Catalog #	Type
Prepared by	Notes	Date



Lumark PRV / PRV-XL Prevail LED

Area / Site Luminaire

Typical Applications
Outdoor - Parking Lots - Walkways - Roadways - Building Areas

Interactive Menu

- Ordering Information [page 2](#)
- Mounting Details [page 3](#)
- Optical Configurations [page 3](#)
- Product Specifications [page 3](#)
- Energy and Performance Data [page 4](#)
- Control Options [page 5](#)

Quick Facts

- Lumen packages range from 7,100 - 48,600 lumens (50W - 350W)
- Replaces 70W up to 1,000W HID equivalents
- Efficacies up to 148 lumens per watt
- Energy and maintenance savings up to 85% versus HID solutions
- Standard universal quick mount arm with universal drill pattern

Dimensional Details

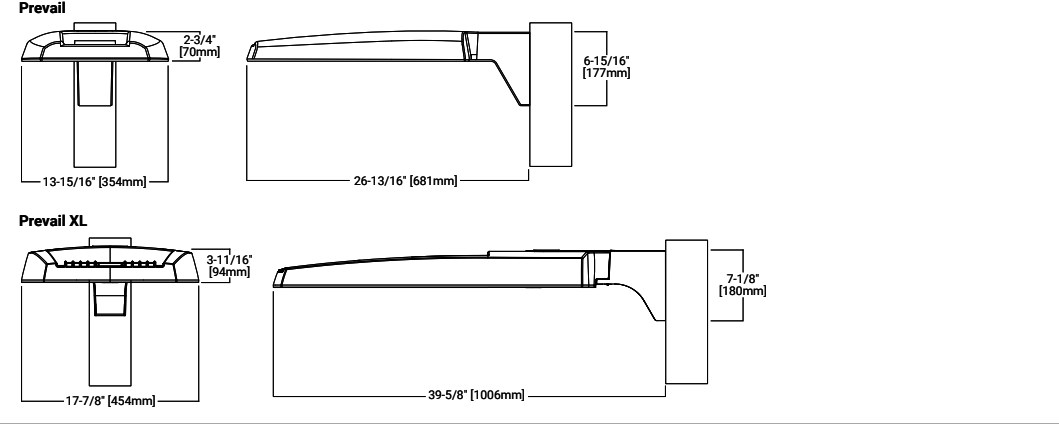

COOPER
Lighting Solutions

PROVIDENT page 1
Rev'd 4/2022 (07/24)

Outdoor
Indoor **WET** **5 Years**
Lifetime

Project: 340 Campbell	Type: Bollard Option	QTY:
Product Code:		

Product Code: **IP55-116577**

COLOR	SIZE	WATT	CCT	DIST.	VOLTAGE	OPTIONS
<input checked="" type="checkbox"/> Black	<input checked="" type="checkbox"/> I	<input checked="" type="checkbox"/> 8W	<input checked="" type="checkbox"/> 822	<input checked="" type="checkbox"/> S = Symmetrical	<input checked="" type="checkbox"/> 120	<input checked="" type="checkbox"/> CH = custom height
<input type="checkbox"/> White	<input type="checkbox"/> II	<input type="checkbox"/> 12W	<input type="checkbox"/> 827	<input type="checkbox"/> F = Forward throw	<input type="checkbox"/> 120/010 = 120V, 0-10 dim	<input type="checkbox"/> GR = GR Receptacle**
<input type="checkbox"/> Aluminum	<input type="checkbox"/> III	<input type="checkbox"/> 18W	<input type="checkbox"/> 830	<input type="checkbox"/> L = Linear walkway	<input type="checkbox"/> 277/010 = 277V, 0-10 dim	<input type="checkbox"/> EM = Emergency back up (available 120V and 0 only)
<input type="checkbox"/> Custom color	<input type="checkbox"/> 24W	<input type="checkbox"/> 835	<input type="checkbox"/> 840		<input type="checkbox"/> 347/010 = 347V, 0-10 dim	

Notes: * 347V available for size I and II only
** Provision for GR receptacles only (receptacle - cover by others)
① applicable to size I
② applicable to size I and II
③ applicable to size I and II

Features + Specifications

Intended Use:

- Building interior/exterior.
- Wet location listed
- 3 sizes available (SIZE I + SIZE II + SIZE III).

Construction:

- Extruded aluminum tube with 1/8\"
- One piece construction for strength.
- HI impact PMMA optical lens with 3 light distribution.
- Light engine compartment sealed off to prevent water & dust ingress.
- Stainless steel base with galvanized anchor rods.

Finish:

- Sand textured powder coat paint with UV additive.
- Color in **Black**, white and aluminum.
- Contact factory for Custom Color.

Optical System:

- Multiple mid-power SMD light module with 3 light distribution.
- L = Linear walkway, F = Forward throw and S = Symmetrical.
- SMD on all aluminum PCB for excellent heat management.
- Oslam Duris 55 3030 SMDs 2200K, 2700K, 3000K, 3500K & 4000K, 80+ CRI.
- 77+lm/W for 2200K, 90+lm/W for other CCTs.
- Check Osram web portal for their latest LM80, and TM21 technical data.

CEC ETL ENEC UL LISTED DGC KC ROHS REACH
Certified to C2.2 No. 250.0 Conformed to UL 1598 (Certification marks (where applicable) will be found on our luminaires and its components)



DELIVERED LUMENS

CCT	8W	12W	18W	24W
822 (2200K)	520	780	1175	1562
827 (2700K)	612	918	1378	1840
830 (3000K)	682	1022	1530	2050
835 (3500K)	745	1170	1753	2339
840 (4000K)	780	1180	1765	2350

www.iplighting.com

IP
LIGHTING

Model: WL-LED100 LEDme® Step Light

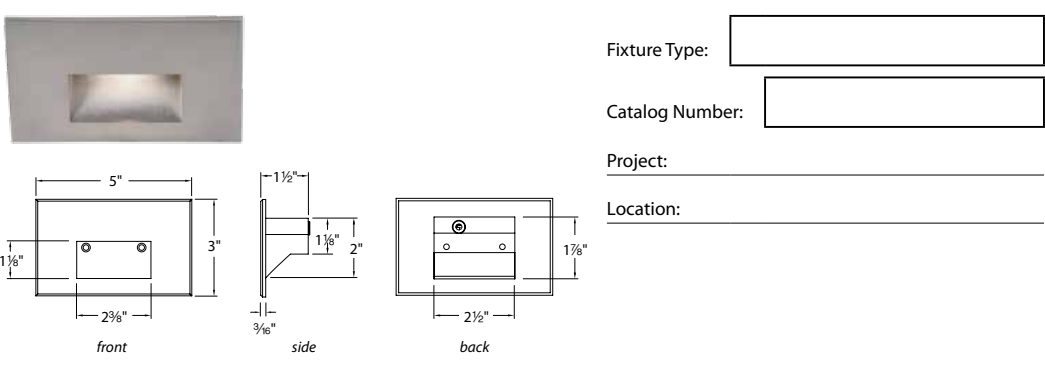

PRODUCT DESCRIPTION
Horizontal rectangle LEDme® Step Light. Designed for safety and style on stairways, patios, decks, balcony areas, walkways and building perimeters. Features an architectural design. Energy efficient for long-lasting indoor and outdoor lighting solutions. Creates an attractive, romantic, impression at night.

FEATURES

- 316 marine grade cast stainless steel (SS) available
- Direct wiring, no driver needed
- Low profile, flush to wall aesthetics with no visible hardware
- Turtle friendly (AMA, RD colors)
- 40,000 hour rated life
- Balanced lighting, free of shadows with minimum glare
- Up to 200 fixtures can be connected in parallel
- Replaceable LED module
- 5 year WAC Lighting product warranty

SPECIFICATIONS

Power: Direct wiring, no remote driver needed. Input voltage: 120V or 277V AC, 50/60Hz

Light Source: 3000K CCT Samsung HW-AC High Power LED, CRI: 85

Optional color lenses: Total power consumption of 3.9W

Mounting: Includes bracket for J-Box mount. See next page for spacing recommendations

Dimming: Dim to 10% with electronic low voltage (ELV) dimmer

Approved dimmers: Lutron Skylark SEL-350R-WH and Lutron Vista VP64

Standards: IP66, UL & cUL Listed for wet locations

FIXTURE PERFORMANCE

Model #	Lm	Model #	Lm	Model #	Lm	Model #	Lm	Model #	Lm
WL-LED100-C-SS	45	WL-LED100-C-BK	31	WL-LED100-C-WT	48	WL-LED100-C-BN	31	WL-LED100-C-BZ	32
WL-LED100-AM-SS	29	WL-LED100-AM-BK	19	WL-LED100-AM-WT	38	WL-LED100-AM-BN	19	WL-LED100-AM-BZ	21
WL-LED100-RD-SS	3	WL-LED100-RD-BK	2	WL-LED100-RD-WT	4	WL-LED100-RD-BN	2	WL-LED100-RD-BZ	2
WL-LED100-BL-SS	3	WL-LED100-BL-BK	3	WL-LED100-BL-WT	8	WL-LED100-BL-BN	3	WL-LED100-BL-BZ	4
WL-LED100F-C-SS	27	WL-LED100F-C-BK	18	WL-LED100F-C-WT	36	WL-LED100F-C-BN	25	WL-LED100F-C-BZ	27
WL-LED100F-AM-SS	20	WL-LED100F-AM-BK	14	WL-LED100F-AM-WT	29	WL-LED100F-AM-BN	14	WL-LED100F-AM-BZ	15
WL-LED100F-RD-SS	2	WL-LED100F-RD-BK	1.5	WL-LED100F-RD-WT	3	WL-LED100F-RD-BN	1.5	WL-LED100F-RD-BZ	2
WL-LED100F-BL-SS	4	WL-LED100F-BL-BK	3	WL-LED100F-BL-WT	6	WL-LED100F-BL-BN	3	WL-LED100F-BL-BZ	3

ORDER NUMBER

Model #	Color	Finish
WL-LED100	C White	SS Stainless Steel
WL-LED100F	AM Amber	BK Black
	RD Red	WT White
	BL Blue	BN Brushed Nickel
		BZ Bronze

Example: WL-LED100F-BL-SS

WAC Lighting
www.waclighting.com
Phone (800) 526-2585 Fax (800) 526-2585
Headquarters/Eastern Distribution Center
44 Harbor Park Drive • Port Washington, NY 11050
Phone (214) 515-5000 Fax (214) 515-5000
Western Distribution Center
1750 Archibald Avenue • Ontario, CA 91760
Phone (800) 526-2585 Fax (800) 526-2585

WAC Lighting retains the right to modify the design of our products at any time as part of the company's continuous improvement program. APR 2014

WAC LIGHTING Responsible Lighting®

Fixture Type:

Catalog Number:

Project:

Location:

Cedarshed Bayside 8x4 Double Door Shed

Model # B84DD | Store SKU # 1001553863

★★★★ (2) | [Write a Review](#) [Q&A \(2\)](#)



6 Gardening shed Scale: 1/2" = 1'-0"

THE CEDARSHED POTTING BENCH is perfect for gardener's tools with generous shelving and a large countertop and sink.

Beautiful and functional Cedarshed furnishings are crafted from Western Red Cedar known for its beauty, durability and outstanding weather resistance. **Free Shipping, Always!**

Potting Bench Features:

- Plastic tray below for mixing soil
- Upper shelf for extra storage
- Assembled Size (WxHxD): 48" x 58" x 24"
- Weight: 80 Lbs.
- Made of top quality 100% Western Red Cedar

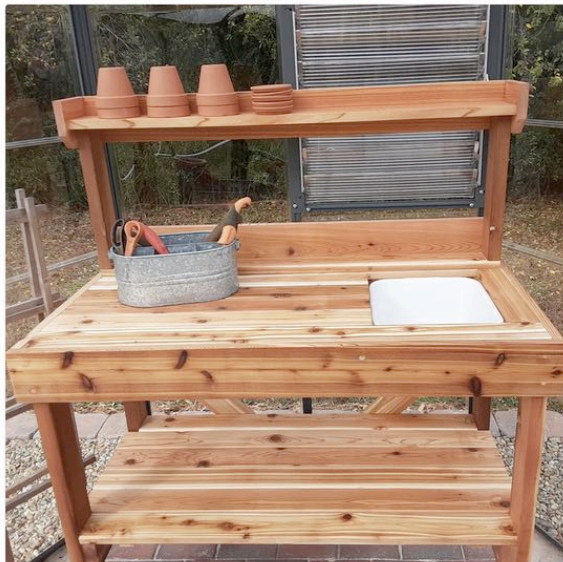

Shop > Shed Kit Options > **Potting Bench**

Potting Bench

CEDARSHED

\$689.00 CAD

☆☆☆☆ No reviews

Quantity

1 +

[ADD TO CART](#)

[Buy with Shop Pay](#)

More payment options

Free shipping over \$50

7 Potting bench Scale: 1/2" = 1'-0"

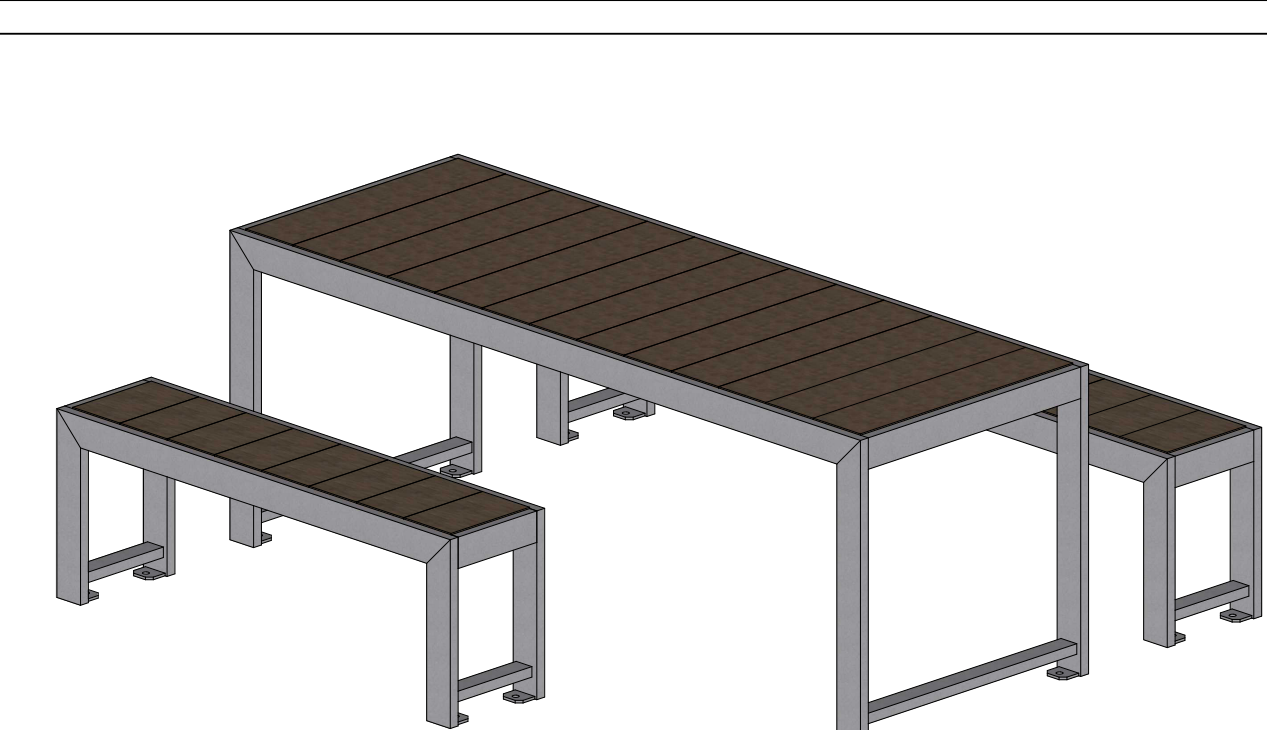

Wishbone
site furnishings

MATERIAL:
ALUMINUM
PATTERN NO.
N/A

DWG. NO.
DWSBPT31012300
MODEL NO.
UPHTWC-8

SCALE:
AS SHOWN

SHEET:
2 OF 2

DATE:
31 JAN 23

DRAWN BY:
J. WRIGHT

DATE:
31 JAN 23

DATE:
31 JAN 23

DATE:
31 JAN 23

DATE:
31 JAN 23

DATE:
31 JAN 23

DATE:
31 JAN 23

DATE:
31 JAN 23

DATE:
31 JAN 23

DATE:
31 JAN 23

DATE:
31 JAN 23

DATE:
31 JAN 23

DATE:
31 JAN 23

DATE:
31 JAN 23

DATE:
31 JAN 23

DATE:
31 JAN 23

DATE:
31 JAN 23

DATE:
31 JAN 23

DATE:
31 JAN 23

DATE:
31 JAN 23

DATE:
31 JAN 23

DATE:
31 JAN 23

DATE:
31 JAN 23

DATE:
31 JAN 23

DATE:
31 JAN 23

DATE:
31 JAN 23

DATE:
31 JAN 23

DATE:
31 JAN 23

DATE:
31 JAN 23

DATE:
31 JAN 23

DATE:
31 JAN 23

DATE:
31 JAN 23

DATE:
31 JAN 23

DATE:
31 JAN 23

DATE:
31 JAN 23

DATE:
31 JAN 23

DATE:
31 JAN 23

DATE:
31 JAN 23

DATE:
31 JAN 23

DATE:
31 JAN 23

DATE:
31 JAN 23

DATE:
31 JAN 23

DATE:
31 JAN 23

DATE:
31 JAN 23

DATE:
31 JAN 23

DATE:
31 JAN 23

DATE:
31 JAN 23

DATE:
31 JAN 23

DATE:
31 JAN 23

DATE:
31 JAN 23

DATE:
31 JAN 23

DATE:
31 JAN 23

DATE:
31 JAN 23

DATE:
31 JAN 23

DATE:
31 JAN 23

DATE:
31 JAN 23

DATE:
31 JAN 23

DATE:
31 JAN 23

DATE:
31 JAN 23

DATE:
31 JAN 23

DATE:
31 JAN 23

DATE:
31 JAN 23

DATE:
31 JAN 23

DATE:
31 JAN 23

DATE:
31 JAN 23

DATE:
31 JAN 23

DATE:
31 JAN 23

DATE:
31 JAN 23

DATE:
31 JAN 23

DATE:
31 JAN 23

DATE:
31 JAN 23

DATE:
31 JAN 23

DATE:
31 JAN 23

DATE:
31 JAN 23

DATE:
31 JAN 23

DATE:
31 JAN 23

DATE:
31 JAN 23

DATE:
31 JAN 23

DATE:
31 JAN 23

DATE:
31 JAN 23

DATE:
31 JAN 23

DATE:
31 JAN 23

DATE:
31 JAN 23

DATE:
31 JAN 23

DATE:
31 JAN 23

DATE:
31 JAN 23

DATE:
31 JAN 23

DATE:
31 JAN 23

DATE:
31 JAN 23

DATE:
31 JAN 23

DATE:
31 JAN 23

DATE:
31 JAN 23

DATE:
31 JAN 23

DATE:
31 JAN 23

DATE:
31 JAN 23

DATE:
31 JAN 23

DATE:
31 JAN 23

DATE:
31 JAN 23

DATE:
31 JAN 23

DATE:
31 JAN 23

DATE:
31 JAN 23

DATE:
31 JAN 23